

Review of Heritage Assessments Submitted to Sefton Council in Support of Proposed Land Allocations:

Appendix 9: AS 28 Land South of Lovelady's Farm, Formby Appendixes

AOC project no 23211

October 2015



Appendix 9.1: AS 28 Gazetteer

Site Number	1
Site Name	Site of Hankey's Barn, Birkley Lane, Formby
Type of Site	Barn
NHLE List Entry Number	
HER Number	MME1101
Status	Non Designated
Easting	329974
Northing	406689
Parish	Formby
Council	Sefton
Description	<p>Former site of Hankey's Barn, Birkey Lane, Formby. (1) A building is shown in the area on Yates' map of 1786. (1) Greenwood's map of 1818 shows a building, possibly two, on the site. (2) Hennessey's map of 1829 shows two buildings on the west side of the lane. (3) The Tithe map of 1845 records the building as No. 167, a barn and fold, leased by Robert Neale and occupied by William Massey. (4-5) The barn was known as Hankey's Barn. It was floored with very thick stone slabs and is said that at one time it housed the lifeboat. Lifeboat House was painted on the fan gable. (6-7) The barn was demolished sometime between 1955 and 1968. BARN (GEORGIAN to LATE 20TH CENTURY - 1786 AD? to 1968 AD?)</p> <p>(1) Archive: Merseyside Sites and Monuments Record. 1977-2011. SMR P sheet. 2906-002 (2) Map: Yates, W.. 1786. Yates' Map of Lancashire. (3) Map: Greenwood, C.. 1818. Greenwood's Map of the County Palatine of Lancaster. (4) Map: Gregson, W.. 1845. Formby Tithe Map. 167 (5) Documentary source: 1845. Formby Tithe Apportionment. 167 (6) Archive: Sibley. Formby Society slides and notes. Slide 47 Drawings 22-24 Newspaper or Magazine: 1963. [A drawing of the Old Lifeboat house in Birkey Lane]. Formby Times. Formby Times 1963</p>

Site Number	2
Site Name	Raven Meol's Farm Farmhouse, No 13 Kew Road Formby
Type of Site	Date Stone; House; Building; House
NHLE List Entry Number	1199137
HER Number	MME899
Status	Listed Building (II)
Easting	328994
Northing	406034
Parish	Formby
Council	Sefton
Description	<p>Raven Meols Farm farmhouse, No. 13 Kew Road, Formby. (1) The building appears on the map of 1778 and is labelled as James Longton. (2) The building is shown on Yates' map of 1786, Greenwood's of 1818 and Hennessey's of 1829. (3-5) The Tithe map of 1845 shows a long building orientated east-west, within the plot No. 37, owned by the Reverend Kesketh Formby's heirs and occupied by Thomas Eccles. It is, however, not described as a building, it is named as Longton Green and is recorded as an arable field. The adjacent plot to the east, No. 36, is recorded as Old Garden. (6-7) The 1st edition 6" OS map of 1848 shows the same building as</p>

the Tithe map but does not shade it and labels it as "Ruin". The 1st edition 25" OS map of 1893 shows all but the eastern extant part of the building to have been demolished and Kew Road to have been laid out crossing the site. It is also labelled as Raven

Meols Farm. The farmhouse appears to have been located to the south east of the extant building. The building is likely to have been disused from the early to mid 19th century, coming back into use after a period as a ruin in the mid to late 19th century, though when it was renovated as a house is less clear. From the National Heritage List for England: SD 20 NE 2/41 FORMBY, KEW ROAD (east side), Raven Meols Farm (Formerly listed as Kew Farmhouse) II Farmhouse. Datestone inscribed: "RL/IL/1733". Roughcast with stone slate roof, some brick to rear. 2 storeys, 2 bays with one storey outshut under lean-to roof to right return. Windows have casements and some horizontally sliding sashes. Central entrance and entrance to outshut. Gable-end stacks. Left return has date stone and truncated external stack.

Listing NGR: SD2899406034 (8)

The date stone read R L J L 1733 on three lines. It has been painted with the characters picked out in black.

DATE STONE (GEORGIAN - 1733 AD)

HOUSE (GEORGIAN to VICTORIAN - 1733 AD to 1845 AD?)

BUILDING? (VICTORIAN - 1845 AD? to 1893 AD?)

HOUSE (VICTORIAN to 21ST CENTURY - 1893 AD? to 2050 AD)

(1) Archive: Merseyside Sites and Monuments Record. 1977-2011. SMR P sheet. 2806-010

(2) Map: 1778. Plan of damaged lands adjoining the River Alt.

(3) Map: Yates, W.. 1786. Yates' Map of Lancashire.

(4) Map: Greenwood, C.. 1818. Greenwood's Map of the County Palatine of Lancaster.

(5) Map: Hennes, G.. 1829. Hennes's Map of the County Palatine of Lancaster.

(6) Map: Gregson, W.. 1845. Formby Tithe Map. 36 and 37

(7) Documentary source: 1845. Formby Tithe Apportionment. 36 and 37

Scheduling record: Historic England. The National Heritage List for England.

<http://list.englishheritage.org.uk/resultsingle.aspx?uid=1075859>

Site Number	3
Site Name	Site of a house, Hogshill Lane, Formby
Type of Site	Building
NHLE List Entry Number	
HER Number	MME1112
Status	Non Designated
Easting	329724
Northing	406266
Parish	Formby
Council	Sefton
Description	<p>Former site of a house, Hogshill Lane, Formby. (1) Yates' map of 1786 only shows one building in the area, most likely No. 11 to the southwest. (2) Greenwood's map of 1818 shows buildings on the north side of the lane. (3) The Tithe map of 1845 records it as No. 120, a cottage and garden owned by Thomas Sutton senior and occupied by Peter Lamb. (4-5) The building is last recorded on the 2nd edition 25" OS map of 1908; it does not appear on the 3rd edition 25" OS map of 1927. BUILDING (GEORGIAN to EARLY 20TH CENTURY - 1818 AD? to 1927 AD?)</p> <p>(1) Archive: Merseyside Sites and Monuments Record. 1977-2011. SMR P sheet. 2906-023 (2) Map: Yates, W.. 1786. Yates' Map of Lancashire. (3) Map: Greenwood, C.. 1818. Greenwood's Map of the County Palatine of Lancaster.</p>

(4) Map: Gregson, W.. 1845. Formby Tithe Map. 120
(5) Documentary source: 1845. Formby Tithe Apportionment. 120

Site Number	4
Site Name	Millstone, No 85 Raven Meols Lane, Formby
Type of Site	Findspot
NHLE List Entry Number	
HER Number	MME1113
Status	Non Designated
Easting	329760
Northing	406640
Parish	Formby
Council	Sefton
Description	<p>Developed for housing. The stone was found in an area of the garden that had not been cultivated for more</p> <p>A worn millstone was found to the rear of No. 85 Raven Meols Lane, Formby in 1978 when the site was being developed for housing. The stone was found in an area of the garden that had not been cultivated for more than 20 years. The stone was said not to have been brought to the site recently as a landscaping feature. The stone is worn from use and is slightly broken on one side. It is 151cms across, the central hole is 31cm across and the stone is 5.5cm to 10cm thick. The upper surface has a series of shallow grooves. The lower msurface is slightly domed roughly dressed and slightly chamfered around the circumference. It is a light red coarse-grained sandstone. The stone was taken to be displayed outside Formby Library. (1) FINDSPOT (POST MEDIEVAL to VICTORIAN - 1540 AD? to 1900 AD?)</p>

(1) Archive: Merseyside Sites and Monuments Record. 1977-2011. SMR F sheet. 2906-024

Site Number	5
Site Name	Site of a row of four cottages, Duke Street, Formby
Type of Site	House
NHLE List Entry Number	
HER Number	MME1116
Status	Non Designated
Easting	329982
Northing	406946
Parish	Formby
Council	Sefton
Description	<p>Former site of a row of four cottages, Duke Street, Formby. (1) No buildings are shown in the area on Greenwood's map of 1818. (2) Hennem's map of 1829 shows a building on the west side of Liverpool Road, south of Duke Street, though not clearly at the junction of the two. It is probable that this row of cottages was intended. (3) The Tithe map of 1845 records it as No. 177, house, outbuildings and garden owned by Thomas Weld Blundell and occupied by Edward Rimmer. (4-5) The building is shown as subdivided on the 1st edition 25" OS map of 1893. The row of cottages were demolished in 1961. (6-7) HOUSE (GEORGIAN to MID 20TH CENTURY - 1829 AD? to 1961 AD)</p>

- (1) Archive: Merseyside Sites and Monuments Record. 1977-2011. SMR P sheet. 2906-027
 (2) Map: Greenwood, C.. 1818. Greenwood's Map of the County Palatine of Lancaster.
 (3) Map: Hennem, G.. 1829. Hennem's Map of the County Palatine of Lancaster.
 (4) Map: Gregson, W.. 1845. Formby Tithe Map. 177
 (5) Documentary source: 1845. Formby Tithe Apportionment. 177
 (6) Archive: Sibley. Formby Society slides and notes. Slide 119 drawing 75
 Newspaper or Magazine: 1969. The western end of Duke Street. Formby Times. Formby Times 10/12/1969

Site Number	6
Site Name	Site of Sott's Cottgae, Liverpool Road, Little Altcar
Type of Site	House
NHLE List Entry Number	
HER Number	MME1348
Status	Non Designated
Easting	330252
Northing	406166
Parish	Altcar
Council	Sefton
Description	Former site of Stott's Cottage, Liverpool Road, Little Altcar. (1-2) A structure is possibly shown on the estate plan of the Manor of Altcar of 1769, in plot No. 33, but it is not shaded as with all other buildings on this plan. (3) No structure is shown on the plan of damaged lands adjoining the River Alt of 1778, though the plot is on the edge of the area mapped and so it may have been excluded. (4) Yates' map of 1786 may show a building in the area. (5) Greenwood's map of 1818 shows the building. (6) The building is last recorded on OS mapping of 1968; it does not appear on the aerial photograph of 1979. HOUSE (GEORGIAN to LATE 20TH CENTURY - 1786 AD? to 1979 AD?)
	(1) Archive: Merseyside Sites and Monuments Record. 1977-2011. SMR P sheet. 3006-001 (2) Archive: Sibley. Formby Society slides and notes. Slide 300-1 Drawing 184-6 (3) Map: 1769. The Manor of Altcar. 33 (4) Map: 1778. Plan of damaged lands adjoining the River Alt. (5) Map: Yates, W.. 1786. Yates' Map of Lancashire. (6) Map: Greenwood, C.. 1818. Greenwood's Map of the County Palatine of Lancaster.

Site Number	7
Site Name	Site of Altcar pound, Lunt's Lane, Altcar
Type of Site	Pound
NHLE List Entry Number	
HER Number	MME1349
Status	Non Designated
Easting	330265
Northing	406193
Parish	Altcar

Council Sefton

Description Former site of Altcar pound, Lunt's Lane, Altcar. (1) The pound is shown on the 1st edition 6" OS map of 1848. It does not appear on the 1st edition 25" OS map of 1893.
POUND (VICTORIAN - 1848 AD? to 1893 AD?)

Merseyside SMR File Reference - 3006-002 Active
(1) Archive: Merseyside Sites and Monuments Record. 1977-2011. SMR P sheet. 3006-002

Site Number 8

Site Name The Cross, Cross Green, Formby

Type of Site Cross

NHLE List Entry Number 1075896

HER Number MME1350

Status Listed Building (II)

Easting 330026

Northing 406931

Parish Formby

Council Sefton

Description The Cross, Cross Green, Formby. (1) In 1879 Mr Weld Blundell claimed the Formby village green as his own and took down the old cross and pedestal and erected a handsome new one. The old cross and steps were then removed to St. Luke's churchyard. (2) From the National Heritage List for England: FORMBY CROSS GREEN SD 30 NW (west side) 3/32 Stone cross in centre of 19.07.66 roundabout II Cross. c.1879. Stone. Base on 3 square steps is octagonal, with broaches at angles. Chamfered shaft with moulded cap. Cross has cusping and ogival terminals to arms. Erected following removal of original cross to churchyard of St. Lukes's Church (q.v.).
Listing NGR: SD3002606931 (3)
CROSS (VICTORIAN to 21ST CENTURY - 1897 AD? to 2050 AD)

Merseyside SMR File Reference - 3006-003 Active
(1) Archive: Merseyside Sites and Monuments Record. 1977-2011. SMR P sheet. 3006-003
Article in serial: Taylor, H.. 1902. The Ancient Crosses of Lancashire. Transactions of the Lancashire and Cheshire Antiquarian Society. Transactions of the Lancashire and Cheshire Antiquarian Society Vol. 19:
153
(2)
Scheduling record: Historic England. The National Heritage List for England.
<http://list.englishheritage.org.uk/resultsingle.aspx?uid=1075896>

Site Number 9

Site Name No 1 Lighthouse Lane, Altcar

Type of Site House

NHLE List Entry Number

HER Number MME1352

Status	Non Designated
Easting	330150
Northing	406109
Parish	Altcar
Council	Sefton
Description	<p>No. 1 Lighthouse Lane, Altcar. In 1982 it consisted of two buildings, Nos. 102 and 104 Liverpool Road. It had three bays with a door to the right within a lean-to porch and a lean-to extension on the east end. It was of brick on a sandstone plinth with some sandstone quoins on the west end. (1-2) A building appears on the site on the 1769 map of the Manor of Altcar, as No. 27. (3) A building is shown on the 1st edition 6" OS map of 1848, as a somewhat irregular structure. The 1st edition 25" OS map of 1893, however, shows three buildings of regular form. These are labelled Robinson's Cottages. The 3rd edition 25" OS map of 1927 appears to show four properties. The OS map of 1984 shows two larger regular buildings. No. 104, the western half of the structure, was demolished in the late 20th century. No. 102, the eastern half, was then substantially modified and extended. It is unclear if any of the earlier structure(s) remains within the central portion of No. 1 Lighthouse Lane and whether any of this might date back to the 18th century or is all of mid to late 19th century date. The building has been further extended, onto the former site of No. 104, in the early 21st century.</p> <p>HOUSE (VICTORIAN to 21ST CENTURY - 1893 AD? to 2050 AD)</p> <p>(1) Archive: Merseyside Sites and Monuments Record. 1977-2011. SMR P sheet. 3006-005 (2) Archive: Merseyside Sites and Monuments Record. 1977-2011. SMR F sheet. 3006-005 (3) Map: 1769. The Manor of Altcar. 27</p>

Site Number	10
Site Name	Rose Cottage
Type of Site	House
NHLE List Entry Number	
HER Number	MME1353
Status	Non Designated
Easting	330175
Northing	406929
Parish	Formby
Council	Sefton
Description	<p>Rose Cottage, Rose Path, Formby. (1-2) A building is shown in the area on Yates' map of 1786 but is more likely to be another building which stood to the west. (3) Greenwood's map of 1818 shows a building on the site. (4) Hennessey's map of 1829 records three buildings on the south side of Cross Green, probably including this building. (5) The Tithe map of 1845 records the building as No. 359, Rose Cottage and Avenue, owned and occupied by Thomas Brown. (6-7) No building is shown on the 1st edition 6" OS map of 1848 however the building is shown on the 1st edition 25" OS map of 1893.</p> <p>HOUSE (GEORGIAN to 21ST CENTURY - 1818 AD? to 2050 AD)</p> <p>(1) Archive: Merseyside Sites and Monuments Record. 1977-2011. SMR P sheet. 3006-006 (2) Archive: Sibley. Formby Society slides and notes. Slide 122 and 177 Drawing 106 (3) Map: Yates, W.. 1786. Yates' Map of Lancashire. (4) Map: Greenwood, C.. 1818. Greenwood's Map of the County Palatine of Lancaster. (5) Map: Hennessey, G.. 1829. Hennessey's Map of the County Palatine of Lancaster.</p>

(6) Map: Gregson, W.. 1845. Formby Tithe Map. 359
(7) Documentary source: 1845. Formby Tithe Apportionment. 359

Site Number	11
Site Name	Site of a post medieval house, Liverpool Road, Altcar
Type of Site	Building
NHLE List Entry Number	
HER Number	MME1354
Status	Non Designated
Easting	330237
Northing	406223
Parish	Altcar
Council	Sefton
Description	<p>Former site of a post medieval house, Liverpool Road, Altcar. (1) The building is recorded on the 1769 map of the Manor of Altcar. (2) The building appears on the 1st edition 25" OS map of 1893. The northern half was demolished before the date of the 2nd edition 25" OS map of 1908. The southern half was last recorded on the 3rd edition 25" OS map of 1927; it was demolished in the mid 20th century, before 1955.</p> <p>BUILDING (GEORGIAN to MID 20TH CENTURY - 1769 AD? to 1955 AD?)</p> <p>(1) Archive: Merseyside Sites and Monuments Record. 1977-2011. SMR P sheet. 3006-007 (2) Map: 1769. The Manor of Altcar.</p>

Site Number	12
Site Name	Site of a post medieval building, Liverpool Road, Altcar
Type of Site	House
NHLE List Entry Number	
HER Number	MME1355
Status	Non Designated
Easting	330205
Northing	406306
Parish	Altcar
Council	Sefton
Description	<p>Former site of a post medieval building, Liverpool Road, Altcar. (1) The building possibly appears on the 1769 map of the Manor of Altcar. (2) The building is last recorded on the 1st edition 25" OS map of 1893; it does not appear on the 2nd edition 25" OS map of 1908.</p> <p>HOUSE (GEORGIAN to EDWARDIAN - 1769 AD? to 1908 AD?)</p> <p>(1) Archive: Merseyside Sites and Monuments Record. 1977-2011. SMR P sheet. 3006-008 (2) Map: 1769. The Manor of Altcar.</p>

Site Number	13
Site Name	Site of a house, Liverpool Road, Altcar
Type of Site	Building
NHLE List Entry Number	
HER Number	MME1356
Status	Non Designated
Easting	330184
Northing	406384
Parish	Altcar
Council	Sefton
Description	<p>Former site of a house, Liverpool Road, Altcar. (1) The building does not appear to be shown on the 1769 map of the Manor of Altcar. (2) It is unclear if it is intended on Yates' map of 1786 or Greenwood's map of 1818 but It is probably shown on Hennet's map of 1829. (3-5) The building is shown on the 1st edition 6" OS map of 1848. It is last recorded on the 3rd edition 25" OS map of 1927; it does not appear on the 6" OS map of 1938.</p> <p>BUILDING (GEORGIAN to MID 20TH CENTURY - 1828 AD? to 1938 AD?)</p> <p>(1) Archive: Merseyside Sites and Monuments Record. 1977-2011. SMR P sheet. 3006-009 (2) Map: 1769. The Manor of Altcar. (3) Map: Yates, W.. 1786. Yates' Map of Lancashire. (4) Map: Greenwood, C.. 1818. Greenwood's Map of the County Palatine of Lancaster. (5) Map: Burdett, P.P.. 1777. Burdett's A Survey of the County Palatine of Chester.</p>

Site Number	14
Site Name	Site of Toad Lane House, Formby Fields, Formby
Type of Site	House
NHLE List Entry Number	
HER Number	MME1357
Status	Non Designated
Easting	330269
Northing	406734
Parish	Formby
Council	Sefton
Description	<p>Former site of Toad Lane House, Formby Fields, Formby. (1) No buildings are shown in the area on Yates' map of 1786. (2) A building is shown on Greenwood's map of 1818. (3) The Tithe map of 1845 records it as No. 389, Toad Lane House and garden, owned by Thomas Weld Blundell and occupied by James Dickinson. (4-5) The 1st edition 6" OS map of 1848 shows the building as one property. The building was painted in about 1883 by Ann Lonsdale Formby. It was thatched and consisted of two parts, one of two bays and the other of three. The two bay part had a second storey and a chimney stack on the gable end. It was apparently known as Norris Cottage and was described in 1971 as long demolished. (6-7)The 1st edition 25" OS map of 1893 shows it subdivided. It is possible that it was demolished an new structures similar to those to the south built on the site. A building is visible on aerial photographs of 1961; it had been replaced by the current structure on the site by the time of aerial photographs of 1979.</p> <p>HOUSE (GEORGIAN to LATE 20TH CENTURY - 1818 AD? to 1971 AD?)</p> <p>(1) Archive: Merseyside Sites and Monuments Record. 1977-2011. SMR P sheet. 3006-010</p>

- (2) Map: Yates, W.. 1786. Yates' Map of Lancashire.
- (3) Map: Greenwood, C.. 1818. Greenwood's Map of the County Palatine of Lancaster.
- (4) Map: Gregson, W.. 1845. Formby Tithe Map. 389
- (5) Documentary source: 1845. Formby Tithe Apportionment. 389
- (6) Newspaper or Magazine: 1971. [Norris Cottage, Formby Fields]. Formby Times. Formby Times 4/8/1971
- (7) Archive: Sibley. Formby Society slides and notes. Drawing 107

Site Number	15
Site Name	Site of four post-medieval houses, Liverpool Road, Formby
Type of Site	House
NHLE List Entry Number	
HER Number	MME1358
Status	Non Designated
Easting	330232
Northing	406414
Parish	Formby
Council	Sefton
Description	<p>Former site of four post medieval houses, Liverpool Road, Formby. (1) Buildings are generally shown in the area on Yates' map of 1786 and on Greenwood's map of 1818 but it is not possible to identify individual structures. (2-3) The Tithe map of 1845 shows four structures, Nos. 428, 430-2, two cottages and garden, a cottage and garden, two cottages and garden and a cottage and garden respectively, all owned and occupied by John Robinson. (4-5) The buildings were known as Robinson's Square. Two of them were thatched and those fronting the road were last used as a sweetshop. (6-7) The last of the buildings were demolished in 1982. HOUSE (GEORGIAN to LATE 20TH CENTURY - 1786 AD? to 1982 AD)</p> <p>(1) Archive: Merseyside Sites and Monuments Record. 1977-2011. SMR P sheet. 3006-011 (2) Map: Yates, W.. 1786. Yates' Map of Lancashire. (3) Map: Greenwood, C.. 1818. Greenwood's Map of the County Palatine of Lancaster. (4) Map: Gregson, W.. 1845. Formby Tithe Map. 428, 430-2 (5) Documentary source: 1845. Formby Tithe Apportionment. 428, 430-2 (6) Archive: Sibley. Formby Society slides and notes. Slide 292-5 Drawing 175-6 Newspaper or Magazine: 1971. [Robinson's Square, Liverpool Road, Formby]. Formby Times. Formby Times 17/11/1971</p>

Site Number	16
Site Name	Site of a house, Liverpool Road, Formby
Type of Site	House
NHLE List Entry Number	
HER Number	MME1359
Status	Non Designated
Easting	330197
Northing	406481

Parish	Formby
Council	Sefton
Description	<p>Former site of a house, Liverpool Road, Formby. (1) The building is probably shown on Yates' map of 1786. (2) The Tithe map of 1845 records it as No. 427, a house, outbuildings and garden leased by the executors of Lawrence Dickinson and occupied by James Maddocks. (3-4) The building was brick-built with a slate roof. It was of two storeys. It was derelict in 1969. (5-6) The building is last recorded on OS mapping of 1968; it does not appear on aerial photographs of 1979.</p> <p>HOUSE (GEORGIAN to LATE 20TH CENTURY - 1786 AD? to 1979 AD?)</p> <p>(1) Archive: Merseyside Sites and Monuments Record. 1977-2011. SMR P sheet. (2) Map: Yates, W.. 1786. Yates' Map of Lancashire. (3) Map: Gregson, W.. 1845. Formby Tithe Map. 427 (4) Documentary source: 1845. Formby Tithe Apportionment. 427 (5) Archive: Sibley. Formby Society slides and notes. Slide 298-9 Drawing 178 Newspaper or Magazine: 1969. [Billy Ball's cottage, Liverpool Road, Formby]. Formby Times. Formby Times 11/6/1969</p>

Site Number	17
Site Name	Site of a house, Coronation Avenue, Formby
Type of Site	House
NHLE List Entry Number	
HER Number	MME1360
Status	Non Designated
Easting	330143
Northing	406687
Parish	Formby
Council	Sefton
Description	<p>Former site of a house, Coronation Avenue, Formby. (1) Buildings are generally shown in the area on Yates' map of 1786 but it is not possible to identify individual structures. (2) The building is probably intended on Greenwood's map of 1818. (3) The Tithe map of 1845 records it as No. 402, a cottage and garden owned by Thomas Weld Blundell and occupied by Thomas Rimmer. (4-5) The building was a single storey thatched structure. (6-7) The building is last recorded on the 1st edition 25" OS map of 1893; it does not appear on the 2nd edition 25" OS map of 1908.</p> <p>HOUSE (GEORGIAN to EDWARDIAN - 1786 AD? to 1908 AD?)</p> <p>(1) Archive: Merseyside Sites and Monuments Record. 1977-2011. SMR P sheet. 3006-017 (2) Map: Yates, W.. 1786. Yates' Map of Lancashire. (3) Map: Greenwood, C.. 1818. Greenwood's Map of the County Palatine of Lancaster. (4) Map: Gregson, W.. 1845. Formby Tithe Map. 402 (5) Documentary source: 1845. Formby Tithe Apportionment. 402 (6) Archive: Sibley. Formby Society slides and notes. Slide 142 Drawing 85-6 (7) Newspaper or Magazine: 1969. Cockle Lane cottages. Formby Times. Formby Times 22/10/1969</p>

Site Number	18
--------------------	----

Site Name	Site of The Waterings, Liverpool Road, Formby
Type of Site	House
NHLE List Entry Number	
HER Number	MME1361
Status	Non Designated
Easting	330108
Northing	406690
Parish	Formby
Council	Sefton
Description	<p>Former site of The Waterings, Liverpool Road, Formby. (1) The building appears to be shown on Greenwood's map of 1818. (2) The building is recorded on the Tithe map of 1845 as No. 403, a cottage and garden owned by Richard Formby MD and occupied by Margaret Swift. (3-4) The building was known as The Waterings. (5-6) The building does not appear to be visible on aerial photographs of 1961.</p> <p>HOUSE (GEORGIAN to MID 20TH CENTURY - 1818 AD? to 1961 AD?)</p> <p>(1) Archive: Merseyside Sites and Monuments Record. 1977-2011. SMR P sheet. 3006-018 (2) Map: Yates, W.. 1786. Yates' Map of Lancashire. (3) Map: Gregson, W.. 1845. Formby Tithe Map. 403 (4) Documentary source: 1845. Formby Tithe Apportionment. 403 (5) Archive: Sibley. Formby Society slides and notes. Drawing 179 Newspaper or Magazine: 1969. [The Waterings, Liverpool Road, Formby]. Formby Times. Formby Times 21/5/1969</p>
Site Number	19
Site Name	Site of Formby Bridewell, Liverpool Road, Formby
Type of Site	Lock Up
NHLE List Entry Number	
HER Number	MME1362
Status	Non Designated
Easting	330019
Northing	406875
Parish	Formby
Council	Sefton
Description	<p>Former site of Formby Bridewell, Liverpool Road, Formby. (1) The structure is too small to be recorded on early mapping. It is shown on the Tithe map of 1845 but is not numbered. (2) The building is labelled as Bridewell on the 1st edition 6" OS map of 1848. It is not shown on the 1st edition 25" OS map of 1893. It was pulled down in c.1893, the stocks formerly stood nearby too. (3)</p> <p>LOCK UP (STUART to VICTORIAN - 1700 AD? to 1893 AD)</p> <p>(1) Archive: Merseyside Sites and Monuments Record. 1977-2011. SMR P sheet. 3006-019 (2) Map: Gregson, W.. 1845. Formby Tithe Map. Article in serial: Taylor, H.. 1902. The Ancient Crosses of Lancashire. Transactions of the Lancashire and Cheshire Antiquarian Society. Transactions of the Lancashire and Cheshire Antiquarian Society Vol. 19:</p>

174

Site Number	20
Site Name	Site of Cross House, Cross Green, Formby
Type of Site	House
NHLE List Entry Number	
HER Number	MME1363
Status	Non Designated
Easting	330036
Northing	406963
Parish	Formby
Council	Sefton
Description	<p>Former site of Cross House, Cross Green, Formby. (1) A building is probably shown on Yates' map of 1786. (2) The Tithe map of 1845 labels the building Cross House and records it as No. 326, Cross House, outbuildings and garden owned by Thomas Weld Blundell and occupied by Thomas Dickinson senior. (3-4) The building consisted of a one storey and attic three bay section with a two storey section to the west. (5) The building is last recorded on the 1st edition 25" OS map of 1893; it does not appear on the 2nd edition 25" OS map of 1908. HOUSE (GEORGIAN to EDWARDIAN - 1786 AD? to 1908 AD?)</p> <p>Merseyside SMR File Reference - 3006-020 Active (1) Archive: Merseyside Sites and Monuments Record. 1977-2011. SMR P sheet. 3006-020 (2) Map: Yates, W.. 1786. Yates' Map of Lancashire. (5) Newspaper or Magazine: 1969. [Cross Green, Formby]. Formby Times. Formby Times 15/10/1969</p>

Site Number	21
Site Name	Site of Laburnam Cottage, Bill's Lane, Formby
Type of Site	Building
NHLE List Entry Number	
HER Number	MME1365
Status	Non Designated
Easting	330054
Northing	406458
Parish	Formby
Council	Sefton
Description	<p>Former site of Laburnam Cottage, Bill's Lane, Formby. (1) The building could be intended on Yates' map of 1786. (2) Greenwood's map of 1818 and Hennem's map of 1829 show a building on the north side of the lane. (3-4) The Tithe map of 1845 records it as No. 131, Laburnam Cottage and yard, leased by Richard Tyrer and occupied by Misses Tunnell. (5-6) The building was last known as Farm Cottage. (7-8) The building is last recorded on the OS map of 1968; it is not visible in aerial photographs of 1979. BUILDING (GEORGIAN to LATE 20TH CENTURY - 1786 AD? to 1979 AD?)</p> <p>(1) Archive: Merseyside Sites and Monuments Record. 1977-2011. SMR P sheet. 3006-022</p>

- (2) Map: Yates, W.. 1786. Yates' Map of Lancashire.
(3) Map: Greenwood, C.. 1818. Greenwood's Map of the County Palatine of Lancaster.
(4) Map: Hennet, G.. 1829. Hennet's Map of the County Palatine of Lancaster.
(5) Map: Gregson, W.. 1845. Formby Tithe Map. 131
(6) Documentary source: 1845. Formby Tithe Apportionment. 131
Newspaper or Magazine: 1972. Dilemma of Bills Lane: Just who was Bill?. Formby Times.
Formby Times
5/7/1972
(7)
(7) Archive: Sibley. Formby Society slides and notes. Slide 40

Site Number	22
Site Name	Site of Lea Farm, Bill's Lane, Formby
Type of Site	House
NHLE List Entry Number	
HER Number	MME1373
Status	Non Designated
Easting	330020
Northing	406443
Parish	Formby
Council	Sefton
Description	<p>Former site of Lea Farm, Bill's Lane, Formby. (1) Greenwood's map of 1818 and Hennet's map of 1829 only show a building on the north side of the lane. (2-3) The Tithe map of 1845 records the building as No. 136, house, outbuildings and fold owned by Thomas Weld Blundell and occupied by Gilbert Tyrer. (4-5) It was a two storey brick-built building of four bays with a string course at the first floor level and a slate roof. There was an outbuilding at the eastern end of the range. (6-8) The building is last recorded on the OS map of 1968, when it is labelled as Lea Farm; it is not visible in aerial photographs of 1979. HOUSE (VICTORIAN to LATE 20TH CENTURY - 1845 AD? to 1979 AD?)</p> <p>(1) Archive: Merseyside Sites and Monuments Record. 1977-2011. SMR P sheet. 3006-022 (2) Map: Greenwood, C.. 1818. Greenwood's Map of the County Palatine of Lancaster. (3) Map: Hennet, G.. 1829. Hennet's Map of the County Palatine of Lancaster. (4) Map: Gregson, W.. 1845. Formby Tithe Map. 136 (5) Documentary source: 1845. Formby Tithe Apportionment. 136 (6) Archive: Sibley. Formby Society slides and notes. Slide 35-9 Newspaper or Magazine: 1972. Dilemma of Bills Lane: Just who was Bill?. Formby Times. Formby Times 5/7/1972 (7) (8) Newspaper or Magazine: 1970. [Lea Farm, Bills Lane, Formby]. Formby Times. Formby Times 1970</p>

Site Number	23
Site Name	Location of Formby New Mill, Redgate, Formby
Type of Site	Windmill
NHLE List Entry Number	

HER Number	MME1374
Status	Non Designated
Easting	330600
Northing	406800
Parish	Formby
Council	Sefton
Description	<p>Location of Formby New Mill, Redgate, Formby. (1) An agreement dated 1539 relates to the construction of a new mill in Formby: William Formby allowed Elys Formby to build a windmill on the Shorte Dalys in Formby. (2) Formby New Mill is shown on a plan produced in relation to a boundary dispute in 1557/8. It is labelled as "the new milne" and shown to the east of Formby. (3)</p> <p>The mill is not shown on Yates' map of 1786. (4) The Tithe map of 1845 records the Short Dales in the area where Buckfast Drive is now located. Plot No. 615 to the west of these is recorded as Mill Hill. (5-6) The site of the mill is not known but it was probably located in this area.</p> <p>WINDMILL (TUDOR to GEORGIAN - 1539 AD to 1786 AD?)</p> <p>(1) Archive: Merseyside Sites and Monuments Record. 1977-2011. SMR P sheet. 3006-034 Documentary source: 1539. Agreement between William Forneby of Forneby, gent. and Elys Forneby of Forneby, yeoman.</p> <p>(2)</p> <p>(3) Map: 1557/8. Map to show the area of Formby, Altcar, Halsall and Down Holland.</p> <p>(4) Map: Yates, W.. 1786. Yates' Map of Lancashire.</p> <p>(5) Map: Gregson, W.. 1845. Formby Tithe Map. 615</p> <p>(6) Documentary source: 1845. Formby Tithe Apportionment. 615</p>

Site Number	24
Site Name	Old Spanker's Cottage, No 38 Liverpool Road, Formby
Type of Site	House
NHLE List Entry Number	1343283
HER Number	MME1376
Status	Listed Building (II)
Easting	330313
Northing	406524
Parish	Formby
Council	Sefton
Description	<p>Old Spanker's Cottage, No. 38 Liverpool Road, Formby. (1) It is unclear if the building is recorded on Yates' map of 1786. (2) It is shown on Greenwood's map of 1818. (3) The Tithe map of 1845 shows the building and records it as No. 144, a cottage and garden, owned by Richard Formby MD and occupied by Thomas Lovelady. (4-5) From the National Heritage List for England:</p> <p>FORMBY LIVERPOOL ROAD SD 30 NW (west side) 3/42 No. 38 (Old Spanker's 30.9.85 Cottage) II House. Probably C18 with alterations. Limewashed brick with thatched roof. One storey with attic, 2 bays, with later one storey lean-to bay to left. Ground floor segmental-headed windows with horizontally sliding sashes; attic has 2 gabled dormer windows with similar sashes. Central gabled porch. 1st bay has 2 entrances, one probably to separate store room. Gable-end stacks and coped gables. Right return has small horizontally sliding sash. Low rear wing.</p> <p>Listing NGR: SD3013406524 (6)</p>

HOUSE (GEORGIAN to 21ST CENTURY - 1786 AD? to 2050 AD)

(1) Archive: Merseyside Sites and Monuments Record. 1977-2011. SMR P sheet. 3006-036
(2) Map: Yates, W.. 1786. Yates' Map of Lancashire.
(3) Map: Greenwood, C.. 1818. Greenwood's Map of the County Palatine of Lancaster.
(4) Map: Gregson, W.. 1845. Formby Tithe Map. 144
(5) Documentary source: 1845. Formby Tithe Apportionment. 144
Scheduling record: Historic England. The National Heritage List for England.
<http://list.englishheritage.org.uk/resultsingle.aspx?uid=1343283>

Site Number	25
Site Name	Site of The Cottage, Altcar Lane, Altcar
Type of Site	House
NHLE List Entry Number	
HER Number	MME1377
Status	Non Designated
Easting	330216
Northing	406178
Parish	Altcar
Council	Sefton
Description	<p>Former site of The Cottage, Altcar Lane, Altcar. (1) The building does not appear on the 1769 map of the Manor of Altcar. (2) It is unclear if it is shown on Yates' map of 1786 or Greenwood's map of 1818, it could be intended on Hennet's map of 1829, but it is not clear. (3-5) The building does appear on the 1st edition 6" OS map of 1848. It was thatched with two chimney stacks. It was demolished in or shortly after 1956. (6) HOUSE (GEORGIAN to MID 20TH CENTURY - 1828 AD? to 1956 AD?)</p> <p>(1) Archive: Merseyside Sites and Monuments Record. 1977-2011. SMR P sheet. 3006-037 (2) Map: 1769. The Manor of Altcar. (3) Map: Yates, W.. 1786. Yates' Map of Lancashire. (4) Map: Greenwood, C.. 1818. Greenwood's Map of the County Palatine of Lancaster. (5) Map: Hennet, G.. 1829. Hennet's Map of the County Palatine of Lancaster. (6) Newspaper or Magazine: 1956. Disappearing thatch at Formby. Liverpool Echo. Liverpool Echo 6/9/1956</p>

Site Number	26
Site Name	Site of a post medieval building, Liverpool Road, Altcar
Type of Site	House; Blacksmiths Workshop
NHLE List Entry Number	
HER Number	MME1378
Status	Non Designated
Easting	330205
Northing	406267
Parish	Altcar

Council	Sefton
Description	<p>Former site of a post medieval building, Liverpool Road, Altcar. (1) The building appears on the 1769 map of the Manor of Altcar. (2) The building is labelled as a smithy on the 2nd edition 25" OS map of 1908 (but not on early or later mapping). It is last recorded on 6" OS mapping of 1955; it does not appear on the OS map of 1968.</p> <p>HOUSE (GEORGIAN to LATE 20TH CENTURY - 1769 AD? to 1968 AD?) BLACKSMITHS WORKSHOP (VICTORIAN to EARLY 20TH CENTURY - 1893 AD? to 1927 AD?)</p> <p>(1) Archive: Merseyside Sites and Monuments Record. 1977-2011. SMR P sheet. 3006-038 (2) Map: 1769. The Manor of Altcar.</p>
Site Number	27
Site Name	Lovelady's Farm, No 110 Liverpool Road, Little Altcar
Type of Site	Farmhouse
NHLE List Entry Number	1075886
HER Number	MME1379
Status	Listed Building (II)
Easting	330134
Northing	406033
Parish	Altcar
Council	Sefton
Description	<p>Lovelady's Farm, No. 110 Liverpool Road, Little Altcar. (1-2) The estate plan of the Manor of Altcar dated 1769 possibly shows two structures on the site, within plot No. 28. (3) The plan of damaged lands of 1778 does not show any buildings on the site. The area is on the edge of the map and so may not have been surveyed. (4) A building is shown in the area on Yates' map of 1786. (5)</p> <p>The undated, but possibly 19th century, plan of damaged lands in Altcar, Down Holland and Formby shows two buildings as the 1769 estate plan appears to. (6) Greenwood's map of 1818 shows three buildings in the area. (7) The house is on a different alignment to the other farm buildings. It is possibly the easternmost building shown on the map of 1769 and the undated map.</p> <p>From the National Heritage List for England: ALTCAR LIVERPOOL ROAD SD 30 NW (west side) 3/9 Lovelady's Farmhouse G.V. II Farmhouse. Probably late C18. Brick with slate roof. 2 storeys, 3 bays. Windows and central entrance have gauged brick cambered arches. Windows have 3-light casements; narrower blind window above entrance is painted. Gable-end stack and stack to rear of ridge. Right return has extension under lean-to roof, with loading door to front. The farmhouse forms a good group with barn and stables (q.v.). Listing NGR: SD3013406033 (8) FARMHOUSE (GEORGIAN to 21ST CENTURY - 1769 AD? to 2050 AD)</p> <p>(1) Archive: Merseyside Sites and Monuments Record. 1977-2011. SMR P sheet. 3006-039 (2) Archive: Merseyside Sites and Monuments Record. 1977-2011. SMR F sheet. 3006-039 (3) Map: 1769. The Manor of Altcar. (4) Map: 1778. Plan of damaged lands adjoining the River Alt. (5) Map: Yates, W.. 1786. Yates' Map of Lancashire. (6) Map: Undated. Plan of damaged lands in Altcar, Down Holland and Formby. (7) Map: Greenwood, C.. 1818. Greenwood's Map of the County Palatine of Lancaster. Scheduling record: Historic England. The National Heritage List for England. http://list.englishheritage.org.uk/resultsingle.aspx?uid=1075886</p>

Site Number	28
Site Name	Coin of Charles II, No 107 Liverpool Road, Formby
Type of Site	Findspot
NHLE List Entry Number	
HER Number	MME1381
Status	Non Designated
Easting	330250
Northing	406150
Parish	Altcar
Council	Sefton
Description	coin of Charles II found in the garden of Stott's Cottage, No. 107 Liverpool Road, Formby in or before June 1960. It is a farthing, dated 1672-5 or 1679. (1) FINDSPOT (STUART - 1672 AD to 1700 AD?)

(1) Archive: Merseyside Sites and Monuments Record. 1977-2011. SMR P sheet. 3006-041

Site Number	29
Site Name	Site of Formby Stocks' Liverpool Road, Formby
Type of Site	Stocks
NHLE List Entry Number	
HER Number	MME1382
Status	Non Designated
Easting	330010
Northing	406880
Parish	Formby
Council	Sefton
Description	Former site of Formby Stocks, Liverpool Road, Formby, the stocks are now in St. Luke's churchyard. They were located in the garden of a property at the junction of Philips Lane and Liverpool Road. (1-2) STOCKS (POST MEDIEVAL to EARLY 20TH CENTURY - 1540 AD? to 1920 AD?)

(1) Archive: Merseyside Sites and Monuments Record. 1977-2011. SMR P sheet. 3006-042
Article in serial: Taylor, H.. 1902. The Ancient Crosses of Lancashire. Transactions of the Lancashire and Cheshire Antiquarian Society. Transactions of the Lancashire and Cheshire Antiquarian Society Vol. 19: 189

Site Number	30
Site Name	No 2 Church Road, Formby
Type of Site	House

NHLE List Entry Number	1198990
HER Number	MME1385
Status	Listed Building (II)
Easting	330165
Northing	407015
Parish	Formby
Council	Sefton
Description	<p>No. 2 Church Road, Formby. A brick-built former farmhouse. There was a brick string course at the first floor level. (1-2) A building is shown in the area on Yates' map of 1786. (3) From the National Heritage List for England:</p> <p>FORMBY CHURCH ROAD SD 30 NW (east side) 3/31 No: 2 II House. C18. Roughcast with slate roof, (stone slates to roof of 1st 2 bays of rear). 2 storeys, 3 bays, the 1st of one storey. Ground floor windows have 2-and 3-light horizontally sliding sashes, 2 with glazing bars. 1st floor has C20 casement and horizontally sliding sash. 1st bay entrance. 3 gable-end stacks. Rear has projecting 1st bay. Some horizontally sliding sashes.</p> <p>Listing NGR: SD3016507015 (4)</p> <p>HOUSE (STUART to 21ST CENTURY - 1700 AD? to 2050 AD)</p> <p>(1) Archive: Merseyside Sites and Monuments Record. 1977-2011. SMR P sheet. 3007-072 (2) Archive: Sibley. Formby Society slides and notes. Slides 105-6 Drawings 65-6 (3) Map: Yates, W.. 1786. Yates' Map of Lancashire. Scheduling record: Historic England. The National Heritage List for England. http://list.englishheritage.org.uk/resultsingle.aspx?uid=1198990</p>

Site Number	31
Site Name	Dolphin Bones
Type of Site	Findspot
NHLE List Entry Number	
HER Number	MME1083
Status	Non Designated
Easting	329461
Northing	405576
Parish	Little Crosby
Council	Sefton
Description	<p>Dolphin bones were found during flood defence works under the railway bridge over the River Alt in Altcar in 1969. Two large vertebrae were found in Downholland Silt. They were found on the Hightown side of the bridge, four or five feet below the present [1969] bed of the river. A subsequent visit to the site in October 1969 found a rib. All three bones had dark staining which was said to be the result of fire. (1)</p> <p>FINDSPOT (LATE MESOLITHIC to EARLY NEOLITHIC - 5000 BC? to 4000 BC?)</p> <p>(1) Archive: Merseyside Sites and Monuments Record. 1977-2011. SMR P sheet. 2904-007</p>

Site Number	32
Site Name	17th century date stone, No 22 Altcar Road, Formby

Type of Site	Findspot
NHLE List Entry Number	
HER Number	MME1401
Status	Non Designated
Easting	330262
Northing	406974
Parish	Formby
Council	Sefton
Description	<p>A 17th century date stone was found in the garden of No. 22 Altcar Road, Formby in the early 1970s. It read R E 1683. It was found when the tablet was turned over. (1-2) No building is shown in the area on Yates' map of 1786, Greenwood's of 1818 or Hennet's of 1829. (3-5) The stone may have arrived at the site at any date after 1683, possibly when No. 22 Altcar Road was built in the late 19th or early 20th century, as rubble recycled from elsewhere.</p> <p>FINDSPOT (STUART - 1683 AD)</p> <p>(1) Archive: Merseyside Sites and Monuments Record. 1977-2011. SMR P sheet. 3007-025 (2) Archive: Sibley. Formby Society slides and notes. (3) Map: Yates, W.. 1786. Yates' Map of Lancashire. (4) Map: Greenwood, C.. 1818. Greenwood's Map of the County Palatine of Lancaster. (5) Map: Hennet, G.. 1829. Hennet's Map of the County Palatine of Lancaster.</p>

Site Number	33
Site Name	The former Mayflower Works, Mayflower Industrial Estate, Liverpool Road, Formby
Type of Site	Marine Workshop; Light Industrial Unit
NHLE List Entry Number	
HER Number	MME9817
Status	Non Designated
Easting	330327
Northing	406365
Parish	Formby
Council	Sefton
Description	<p>The former Mayflower Works, a 20th century light engineering facility. Mayflower Works was run by Eastwood and Dickinson Ltd. It was the last block making firm in Liverpool. It produced blocks and deadeyes for historic replicas of the Mayflower and the Nonsuch. Much of the machinery was brought from the original works in Liverpool where it was driven from line shafting. The machinery and buildings were sold in July 1969, the drilling machine was bought by Liverpool Museum. A complete photographic record of all processes of manufacture together with a tap recording of an interview with the foreman were made by the museum. (1)</p> <p>The building does not appear on the OS map of 1955; it is first recorded on aerial photographs of 1961.</p> <p>MARINE WORKSHOP (MID 20TH CENTURY to LATE 20TH CENTURY - 1961 AD? to 1969 AD?) LIGHT INDUSTRIAL UNIT (LATE 20TH CENTURY to 21ST CENTURY - 1969 AD? to 2050 AD)</p> <p>(1) Archive: Merseyside Sites and Monuments Record. 1977-2011. SMR F sheet. 3006-044</p>

Site Number	34
Site Name	No 19 Birkey Lane. Formby
Type of Site	House; Public House
NHLE List Entry Number	
HER Number	MME11765
Status	Non Designated
Easting	329978
Northing	406706
Parish	Formby
Council	Sefton
Description	<p>No. 19 Birkey Lane, Formby. A building is shown in the area on Yates' map of 1786. (1) Greenwood's map of 1818 shows a building, possibly two, on the site. (2) Hennes' map of 1829 shows two buildings on the west side of the lane. (3) The Tithe map of 1845 records the building as No. 169, a house and garden, leased by Robert Neale and occupied by William Massey. (4-5) The building was at one time a small pub and was called The Lifeboat. (6)</p> <p>HOUSE (GEORGIAN to 21ST CENTURY - 1786 AD? to 2050 AD) PUBLIC HOUSE? (GEORGIAN to VICTORIAN - 1800 AD? to 1845 AD?)</p>

- (1) Map: Yates, W.. 1786. Yates' Map of Lancashire.
(2) Map: Greenwood, C.. 1818. Greenwood's Map of the County Palatine of Lancaster.
(3) Map: Hennes, G.. 1829. Hennes' Map of the County Palatine of Lancaster.
(4) Map: Gregson, W.. 1845. Formby Tithe Map. 169
(5) Documentary source: 1845. Formby Tithe Apportionment. 169
(6) Archive: Sibley. Formby Society slides and notes. Slide 47 Drawings 22-24

Site Number	35
Site Name	Site of a barn or outbuilding, Hogshill Lane, Formby
Type of Site	Outbuilding
NHLE List Entry Number	
HER Number	MME11766
Status	Non Designated
Easting	329744
Northing	406248
Parish	Formby
Council	Sefton
Description	<p>Former site of a barn or outbuilding, Hogshill Lane, Formby. Yates' map of 1786 only shows one building in the area, most likely No. 11 to the southwest. (1) Greenwood's map of 1818 shows buildings on the north side of the lane. (2) The Tithe map of 1845 shows a building and records it as either part of No. 121, a croft owned by Thomas Sutton senior and occupied by Peter Lamb, or No. 122, an arable field named Simners Ground occupied by Elizabeth Turner. (3-4) The building is last recorded on the 1st edition 6" OS map of 1848; it does not appear on the 1st edition 25" OS map of 1893.</p> <p>OUTBUILDING? (GEORGIAN to VICTORIAN - 1818 AD? to 1893 AD?)</p>

- (1) Map: Yates, W.. 1786. Yates' Map of Lancashire.
(2) Map: Greenwood, C.. 1818. Greenwood's Map of the County Palatine of Lancaster.
(3) Map: Gregson, W.. 1845. Formby Tithe Map. 120
(4) Documentary source: 1845. Formby Tithe Apportionment. 120

Site Number	36
Site Name	Site of an outbuilding, Cross Green, Formby
Type of Site	Outbuilding
NHLE List Entry Number	
HER Number	MME11800
Status	Non Designated
Easting	330069
Northing	406954
Parish	Formby
Council	Sefton
Description	Former site of an outbuilding, Cross Green, Formby. The building could be shown on Yates' map of 1786. (1) The Tithe map of 1845 shows the building but does not number it separately. It is probably one of the outbuildings included in No. 326, Cross House and outbuildings. (2-3) The building is last recorded on the 1st edition 6" OS map of 1848; it does not appear on the 1st edition 25" OS map of 1893. OUTBUILDING (GEORGIAN to VICTORIAN - 1786 AD? to 1893 AD?)

- (1) Map: Yates, W.. 1786. Yates' Map of Lancashire.
(2) Map: Gregson, W.. 1845. Formby Tithe Map. 326
(3) Documentary source: 1845. Formby Tithe Apportionment. 326

Site Number	37
Site Name	No 1 and 2, The Barns, Liverpool Road, Little Altcar
Type of Site	Stable; House
NHLE List Entry Number	1198854
HER Number	MME11801
Status	Listed Building (II)
Easting	330124
Northing	406062
Parish	Altcar
Council	Sefton
Description	Nos. 1 and 2, The Barns, Liverpool Road, Little Altcar. (1-2) The estate plan of the Manor of Altcar dated 1769 possibly shows two structures on the site, within plot No. 28. (3) The plan of damaged lands of 1778 does not show any buildings on the site. The area is on the edge of the map and so may not have been surveyed. (4) A building is shown in the area on Yates' map of 1786. (5) The undated, but possibly 19th century, plan of damaged lands in Altcar, Down Holland and Formby shows two buildings as the 1769 estate plan appears to. (6) Greenwood's map of 1818 shows three buildings in the area. (7)

The house is on a different alignment to the other farm buildings. The Barns were probably built in the early 19th century, replacing the second of the two structures shown on the 18th century mapping.

From the National Heritage List for England: ALTCAR LIVERPOOL ROAD SD 30 NW (west side) 3/11 Stables to north of Lovelady's Farmhouse G.V. II

Stables. Probably early C19. Brick with slate roof. 2 storeys, 6 bays with one-storey bay under lean-to roof on right return. Segmental-headed windows and entrances, one window with a cut-brick flat arch and one entrance with stone lintel. One 1st floor loading door. Interior has some stables, retaining stable partitions and mangers. Roof has fish-bone trusses. The stables form a good group with farmhouse and barn (q.v.). Included for group value.

Listing NGR: SD3012406062 (8)

STABLE (GEORGIAN to LATE 20TH CENTURY - 1818 AD? to 2000 AD?)

HOUSE (LATE 20TH CENTURY to 21ST CENTURY - 2000 AD? to 2050 AD)

(1) Archive: Merseyside Sites and Monuments Record. 1977-2011. SMR P sheet. 3006-039

(2) Archive: Merseyside Sites and Monuments Record. 1977-2011. SMR F sheet. 3006-039

(3) Map: 1769. The Manor of Altcar.

(4) Map: 1778. Plan of damaged lands adjoining the River Alt.

(5) Map: Yates, W.. 1786. Yates' Map of Lancashire.

(6) Map: Undated. Plan of damaged lands in Altcar, Down Holland and Formby.

(7) Map: Greenwood, C.. 1818. Greenwood's Map of the County Palatine of Lancaster.

Scheduling record: Historic England. The National Heritage List for England.

<http://list.englishheritage.org.uk/resultsingle.aspx?uid=1198854>

Site Number	38
Site Name	No 3 and 4, The Barns, Liverpool Road, Little Altcar
Type of Site	Barn; House
NHLE List Entry Number	1343259
HER Number	MME11802
Status	Listed Building (II)
Easting	330100
Northing	406058
Parish	Altcar
Council	Sefton
Description	<p>Nos. 3 and 4, The Barns, Liverpool Road, Little Altcar. (1-2) The estate plan of the Manor of Altcar dated 1769 possibly shows two structures on the site, within plot No. 28. (3) The plan of damaged lands of 1778 does not show any buildings on the site. The area is on the edge of the map and so may not have been surveyed. (4) A building is shown in the area on Yates' map of 1786. (5)</p> <p>The undated, but possibly 19th century, plan of damaged lands in Altcar, Down Holland and Formby shows two buildings as the 1769 estate plan appears to. (6) Greenwood's map of 1818 shows three buildings in the area. (7)</p> <p>The house is on a different alignment to the other farm buildings. The Barns were probably built in the early 19th century, replacing the second of the two structures shown on the 18th century mapping. The former barn is, however, thought to be of late 18th century date. From the National Heritage List for England: ALTCAR LIVERPOOL ROAD SD 30 NW (west side) 3/10 Barn to north west of Lovelady's Farmhouse G.V. II Barn. C18. Brick with stone slate roof. Diamond pattern ventilation holes, those to left are blocked. Entrance with cheeks and barn doors, rear entrance blocked. Interior has 5 bays with collar and strut trusses on internal buttresses. The barn forms a good group with farmhouse and stables (q.v.). Listing NGR: SD3010006058 (8)</p> <p>BARN (GEORGIAN to LATE 20TH CENTURY - 1787 AD? to 2000 AD?)</p>

HOUSE (LATE 20TH CENTURY to 21ST CENTURY - 2000 AD? to 2050 AD)

(1) Archive: Merseyside Sites and Monuments Record. 1977-2011. SMR P sheet. 3006-039
(2) Archive: Merseyside Sites and Monuments Record. 1977-2011. SMR F sheet. 3006-039
(3) Map: 1769. The Manor of Altcar.
(4) Map: 1778. Plan of damaged lands adjoining the River Alt.
(5) Map: Yates, W.. 1786. Yates' Map of Lancashire.
(6) Map: Undated. Plan of damaged lands in Altcar, Down Holland and Formby.
(7) Map: Greenwood, C.. 1818. Greenwood's Map of the County Palatine of Lancaster.
Scheduling record: Historic England. The National Heritage List for England.
<http://list.englishheritage.org.uk/resultsingle.aspx?uid=1343259>

Site Number	39
Site Name	Mayflower House, Mayflower Industrial Estate, Liverpool Road, Formby
Type of Site	Brewery; Light Industrial Unit; Grage
NHLE List Entry Number	
HER Number	MME11805
Status	Non Designated
Easting	330299
Northing	406389
Parish	Sefton
Council	Formby
Description	Mayflower House, Mayflower Industrial Estate, Liverpool Road, Formby, a mid to late 19th century brewery building. No buildings are shown on the 1st edition 6" OS map of 1848. The buildings first appear on the 1st edition 25" OS map of 1893, when three separate structures are shown along the northern boundary of the site. They were labelled as Reciprocity Brewery. The 2nd edition 25" OS map of 1908 labels the brewery as disused. The 3rd edition 25" OS map of 1927 shows the western most building to have been demolished. The OS map of 1968 shows the buildings connected with an additional range added to the southern front of the easternmost structure. They possibly formed part of Mayflower Works, a light engineering facility. In the 21st century they were in use as a garage.

Site Number	40
Site Name	Pump and Trough to south of Hoggshill Farmhouse, Hoggs Hill, Altcar
Type of Site	Trough; Water Pump
NHLE List Entry Number	1343258
HER Number	MME13334
Status	Listed Building (II)
Easting	329721
Northing	406206
Parish	Altcar
Council	Sefton
Description	From the National Heritage List for England: SD 20 NE 2/8 ALT CAR, HOGGSHILL LANE (south

side), Pump and trough to south of Hoggshill Farmhouse 19.7.74
G.V. II Pump and trough. C19. Iron pump is complete and has large stone trough. Situated in flagged yard behind the house.

Listing NGR: SD2972106206 (1)

TROUGH (GEORGIAN to 21ST CENTURY - 1800 AD? to 2050 AD)

WATER PUMP (GEORGIAN to 21ST CENTURY - 1800 AD? to 2050 AD)

Scheduling record: Historic England. The National Heritage List for England.
<http://list.historicengland.org.uk/resultsingle.aspx?uid=1343258>

Site Number	41
Site Name	Site of Headless Cross, Formby
Type of Site	Cross; Boundary Stone
NHLE List Entry Number	
HER Number	MME1098
Status	Non Designated
Easting	329270
Northing	405750
Parish	Formby
Council	Sefton
Description	<p>Former site of Headless Cross, Formby. (1) The 1769 map of the manor of Altcar has a label which reads "Headless Cross". It is not clear where the stone was located though a possible mark is shown nearby. (2) Two boundary stones are shown on the 1st edition 6" OS map of 1848. Only the northern one is shown on the 1st edition 25" OS map of 1893. The stone may have been a post medieval boundary cross that was later used as a boundary stone.</p> <p>CROSS? (TUDOR to GEORGIAN - 1500 AD? to 1769 AD?) BOUNDARY STONE (GEORGIAN to VICTORIAN - 1769 AD? to 1893 AD?)</p> <p>(1) Archive: Merseyside Sites and Monuments Record. 1977-2011. SMR P sheet. 2905-010 (2) Map: 1769. The Manor of Altcar.</p>

Site Number	42
Site Name	Site of the Bickkiln Hole, Formby
Type of Site	Clay Pit
NHLE List Entry Number	
HER Number	MME1099
Status	Non Designated
Easting	329250
Northing	405900
Parish	Formby
Council	Sefton
Description	<p>Former site of the Brickkiln Hole, Formby. (1) The Formby Manor Court Roll records an order, dated November 1757, to John Rimmer to fill up the Brickkiln Hole up at the south end of the Longdales, before 24th July 1758. (2) The Tithe map of 1845</p>

records two plots, Nos. 92 and 93, as Clay Holes. (3-4) The brick kiln may have been located in the immediate vicinity.

CLAY PIT (GEORGIAN - 1757 AD? to 1758 AD?)

(1) Archive: Merseyside Sites and Monuments Record. 1977-2011. SMR P sheet. 2905-011

(2) Documentary source: 1757-1815. Formby Manor Court Roll. November 1757

(3) Map: Gregson, W.. 1845. Formby Tithe Map. 92 and 93

(4) Documentary source: 1845. Formby Tithe Apportionment. 92 and 93

Site Number	43
Site Name	No 59-63 Raven Meols Lane, Formby
Type of Site	House
NHLE List Entry Number	
HER Number	MME1100
Status	Non Designated
Easting	329599
Northing	406606
Parish	Formby
Council	Sefton
Description	<p>Former site of Nos. 59-63 Raven Meols Lane, Formby. (1) A row of brick-built houses. No. 59 was in a poor state of repair. It was a single-bay with lean-to extensions to the rear. There was one room on the ground floor, with the extension divided into three, and two rooms upstairs. The last tenant died in 1971. No. 61 was of two bays with rear lean-to extension and attached outbuildings. No. 63 was in the process of being renovated in 1980. (2) Previously Listed Grade III: Nos. 61 and 63 C18 early, with alterations, 2 storey including gabled dormers, 2 and 1 windows respectively. Slate roof. 1st floor band. Near-flush sliding casements. Lawned garden. (3) The buildings were upgraded to Grade II in 1972. (4) The buildings were last recorded on an OS map of 1984.</p> <p>HOUSE (STUART to LATE 20TH CENTURY - 1700 AD? to 1984 AD?)</p> <p>Archive: Merseyside Sites and Monuments Record. 1977-2011. SMR P sheet. (2) Archive: Merseyside Sites and Monuments Record. 1977-2011. SMR F sheet. 2906-001 Scheduling record: Ministry of Housing and Local Government. 1965. Formby Urban District Provisional List. 1/23 (3)Scheduling record: Ministry of Housing and Local Government. 1972. Urban District of Formby List No. 4. 1/23 (4)Listed Building (DL) Nos. 61 and 63 Raven Meols Lane Revoked DME3125 Document G:\MerseysideEAS\Historic Environment Record\Reports\SME3 - 2906-001, Raven Meols Lane, Formby.pdf#G:\MerseysideEAS\Historic Environment Record\Reports\SME3 - 2906-001, Raven Meols Lane, Formby.pdf#</p>

Site Number	44
Site Name	Site of a house, Duke Street, Formby
Type of Site	House
NHLE List Entry Number	
HER Number	MME1102

Status	Non Designated
Easting	329503
Northing	406903
Parish	Formby
Council	Sefton
Description	<p>Former site of a house, Duke Street, Formby. (1) Two buildings are shown in the area on Yates' map of 1786. (2) Greenwood's map of 1818 shows the building. (3) The Tithe map of 1845 records the building as No. 299, house, outbuildings and garden, owned by the Reverend Miles Formby and occupied by Margaret Aindow. (4-5) The easternmost end was a thatched cottage with a central ridge stack and another brick chimney stack at the east gable end. It had four bays and a rear extension with a slate roof and a brick chimney stack to the rear. It was in an advanced state of decay in 1953. (6) The building was demolished in the late 1950s and the present building built before 1961, as visible on aerial photos of that date.</p> <p>HOUSE (GEORGIAN to MID 20TH CENTURY - 1786 AD? to 1961 AD?)</p> <p>(1) Archive: Merseyside Sites and Monuments Record. 1977-2011. SMR P sheet. (2) Map: Yates, W.. 1786. Yates' Map of Lancashire. (3) Map: Greenwood, C.. 1818. Greenwood's Map of the County Palatine of Lancaster. (4) Map: Gregson, W.. 1845. Formby Tithe Map. 299 (5) Documentary source: 1845. Formby Tithe Apportionment. 299 Newspaper or Magazine: 1981. Cottage listed by village historian. Formby Times. Formby Times 18th November 1981</p>
Site Number	45
Site Name	Site of cruck-frames house, Elbow Lane, Formby
Type of Site	Cruck House
NHLE List Entry Number	
HER Number	MME1103
Status	Non Designated
Easting	329794
Northing	406964
Parish	Formby
Council	Sefton
Description	<p>Former site of a cruck-framed house, Elbow Lane, Formby. (1) No building appears to be shown on Yates' map of 1786. (2) The building is shown on Greenwood's map of 1818. (3) The Tithe map of 1845 shows a long structure running along the east side of Elbow Lane to the junction with Duke Street, recording it as No. 321, house, outbuildings and croft owned by Gilbert Bolton (lessee) and occupied by Thomas Howard. (4-5) The 1st edition 6" OS map of 1848 shows the same arrangement, with a small outbuilding to the north along with a well. The 1st edition 25" OS map of 1893 shows the southern half of the building to have been demolished. The building consisted of three sections; the oldest was at the northern end. This section was demolished in 1957 when it was found to have timber beams "stuck into the ground and curved right to the roof". The interior walls were of wattle and daub and the exterior of 2" handmade bricks. The roof was thatched and there was one small room on the ground floor with a second even smaller room under the roof. The middle section was also thatched and thought to be more recent in date. The southern end of the building was a two bay two storey late 19th century addition, thought to have been built in c.1890. The two thatched</p>

sections were demolished and a two storey one bay extension added in their place. (6-7)
CRUCK HOUSE (GEORGIAN to MID 20TH CENTURY - 1786 AD? to 1957 AD)

- (1) Archive: Merseyside Sites and Monuments Record. 1977-2011. SMR P sheet. 2906-007
- (2) Map: Yates, W.. 1786. Yates' Map of Lancashire.
- (3) Map: Greenwood, C.. 1818. Greenwood's Map of the County Palatine of Lancaster.
- (4) Map: Gregson, W.. 1845. Formby Tithe Map. 321
- (5) Documentary source: 1845. Formby Tithe Apportionment. 321
Newspaper or Magazine: 1957. Home of the "Anatomical" shoemaker. Formby Times. Formby Times
November 1957
- (6)
- (7) Archive: Sibley. Formby Society slides and notes. Slide 169 Drawing 100

Site Number	46
Site Name	Site of a house, Phillip's Lane, Formby
Type of Site	Cow House; House
NHLE List Entry Number	
HER Number	MME1104
Status	Non Designated
Easting	329811
Northing	406787
Parish	Formby
Council	Sefton
Description	<p>Former site of a house, Phillip's Lane, Formby. (1) A building is shown in the area on Yates' map of 1786. (2) The Tithe map of 1845 records it as No. 164, a house cottage and garden leased and occupied by Thomas Rimmer. (3-4) The buildings were a double-fronted brick-built house and a brick-built barn or shippon with a set of external stone stairs providing access to the first floor. (5) The buildings were demolished before 1961, as shown on aerial photos of that date. COW HOUSE? (GEORGIAN to MID 20TH CENTURY - 1786 AD? to 1961 AD?) HOUSE (GEORGIAN to MID 20TH CENTURY - 1786 AD? to 1961 AD?)</p> <p>(1) Archive: Merseyside Sites and Monuments Record. 1977-2011. SMR P sheet. 2906-008 (2) Map: Yates, W.. 1786. Yates' Map of Lancashire. (3) Map: Gregson, W.. 1845. Formby Tithe Map. 164 (4) Documentary source: 1845. Formby Tithe Apportionment. 164 (5) Archive: Sibley. Formby Society slides and notes. Slide 349 Drawing 230-2</p>

Site Number	47
Site Name	Site of Park Farm, Park Road, Formby
Type of Site	Cow House; Farmhouse
NHLE List Entry Number	
HER Number	MME1105
Status	Non Designated
Easting	329375

Northing	406515
Parish	Formby
Council	Sefton
Description	<p>Site of Park Farm, Park Road, Formby. (1) A building is shown in the area on Yates' map of 1786. (2) Greenwood's map of 1818 shows the building. (3) The Tithe map of 1845 shows a long irregular range of buildings, labels it as Raven Meols and records it as No. 105, house, outbuilding and garden owned by the Reverend Miles Formby and occupied by Robert Neale. (4-5) The 1st edition 6" OS map of 1848 shows the same arrangement but labels it as Park House. The 1st edition 25" OS map of 1893 labels it as Park Farm. The oldest parts of the farm dated to the 18th century but there was also a date stone on one wall which read 1837. The house was at the western end and had three chimney stacks. There was a large catslide roof. There were shippons to the east with an external staircase. It was demolished in the mid 1960s. (6-7)</p> <p>COW HOUSE (GEORGIAN to LATE 20TH CENTURY - 1786 AD? to 1969 AD?) FARMHOUSE (GEORGIAN to LATE 20TH CENTURY - 1786 AD? to 1969 AD?)</p> <p>(1) Archive: Merseyside Sites and Monuments Record. 1977-2011. SMR P sheet. 2906-009 (2) Map: Yates, W.. 1786. Yates' Map of Lancashire. (3) Map: Greenwood, C.. 1818. Greenwood's Map of the County Palatine of Lancaster. (4) Map: Gregson, W.. 1845. Formby Tithe Map. 105 (5) Documentary source: 1845. Formby Tithe Apportionment. 105 (6) Archive: Sibley. Formby Society slides and notes. Slide 368-370 drawing 245 Newspaper or Magazine: 1969. Park Farm, Ravenmeols Lane, in about 1963. Formby Times. Formby Times 31/12/1969</p>

Site Number	48
Site Name	Site of house, Raven Meols Lane, Formby
Type of Site	House
NHLE List Entry Number	
HER Number	MME1106
Status	Non Designated
Easting	329299
Northing	406604
Parish	Formby
Council	Sefton
Description	<p>Former site of a house, Raven Meols Lane, Formby. (1) No building is shown in the area on Yates' map of 1786. (2) Greenwood's map of 1818 shows the building. (3) The Tithe map of 1845 records the building as No. 202, a cottage and garden owned by Dr Richard Formby but unoccupied. (4-5) The house was a two storey four bay structure with two chimney stacks. (6-7)</p> <p>The building is visible on aerial photographs of 1961 but not on OS mapping of 1968. HOUSE (GEORGIAN to LATE 20TH CENTURY - 1818 AD? to 1968 AD?)</p> <p>(1) Archive: Merseyside Sites and Monuments Record. 1977-2011. SMR P sheet. 2906-010 (2) Map: Yates, W.. 1786. Yates' Map of Lancashire. (3) Map: Greenwood, C.. 1818. Greenwood's Map of the County Palatine of Lancaster. (4) Map: Gregson, W.. 1845. Formby Tithe Map. 202 (5) Documentary source: 1845. Formby Tithe Apportionment. 202 (6) Archive: Sibley. Formby Society slides and notes. Drawing 201</p>

(7) Newspaper or Magazine: 1969. Ravenmeols Lane. Formby Times. Formby Times 18/6/1969

Site Number	49
Site Name	Site of St Luke's School, Raven Meols Lane, Formby
Type of Site	School; House
NHLE List Entry Number	
HER Number	MME1107
Status	Non Designated
Easting	329423
Northing	406605
Parish	Formby
Council	Sefton
Description	<p>Former site of St. Luke's School, Raven Meols Lane, Formby. (1) No building is shown on the 1st edition 6" OS map of 1848. The school is shown on the 1st edition 25" OS map of 1893. It is labelled as a school on the 2nd edition 25" OS map of 1908 but not on the 3rd edition 25" OS map of 1927. The building is visible on aerial photographs of 1979 but is not recorded on the OS map of 1984. The school later became a cottage. (2)</p> <p>SCHOOL (VICTORIAN to EARLY 20TH CENTURY - 1893 AD? to 1927 AD?)</p> <p>HOUSE (EARLY 20TH CENTURY to LATE 20TH CENTURY - 1927 AD? to 1984 AD?)</p> <p>(1) Archive: Merseyside Sites and Monuments Record. 1977-2011. SMR P sheet. 2906-013</p> <p>(2) Newspaper or Magazine: 1970. St Lukes School. Formby Times. Formby Times 24/6/1970</p>

Site Number	50
Site Name	Deans Cottage, Park Road, Formby
Type of Site	Cruck House
NHLE List Entry Number	1075865
HER Number	MME1114
Status	Listed Building (II)
Easting	329429
Northing	406534
Parish	Formby
Council	Sefton
Description	<p>Deans Cottage, Park Road, Formby, a 16th century cruck-framed building. (1-2)</p> <p>The building is of three bays. The door opens to a central room open to the rafters. A brick fireplace divides the room from the parlour at the eastern end. The fire is screened from draughts by a spere. The parlour has two small windows on the north and south sides. The bedroom above is reached by a steep wooden staircase and has a small window in the east wall. A similar bedroom with its own staircase is above the kitchen at the western end of the cottage. The timber-framed dividing walls were filled with wattle and daub. The outer walls are local dark red-brown bricks. (3) The building was declared unfit for habitation in 1978/9 and sold by the trustees of the Formby estates.</p> <p>Permission was granted for modernisation that would retain the character of the building. The cruck frame was exposed during renovations in June 1980. Door frames were visible at ground</p>

and first floor levels, both had iron hinges. Two wind braces were visible on the east sides of the cruck. The 'baffle' inside the front entrance was removed. A sherd, possibly a 17th century strap handle, possibly a Rainford type-ware, was found between the base of a cruck and a sandstone pad. A sherd of 18th century black glazed flatware was found above a compacted floor in a layer of rubble levelling. This same layer also produced a fragment of thick green flat glass, animal bone and cockle shells. The cottage was completely reroofed in August 1980 and the brick walls were taken down but rebuilt using the same bricks. The floor has been stripped out and is now concreted in. Three further sherds were found during the removal of the sandy layer beneath the floor tiles, two of 18th century and one of 18th or 19th century date. A bread oven was found on the south side of the chimney, with a blocked door on the north side. A blocked window was found on the north wall near the chimney. Timber wall plates were found on the north wall. The west gable end, in the south corner, had a sandstone block, possibly a former cruck base support. There was another sandstone block adjacent to the cruck frame on the south side, but the cruck no longer rested on it, it having slipped badly from its original position. (4)

From the National Heritage List for England: FORMBY WINDSOR ROAD SD 20 NE (west side) 2/55 Dean's Cottage (formerly listed under Ravenmeols 14.06.63 Lane) II House. Probably C16. Cruck-framed. Brick with half-hipped thatched roof. One storey with attic, 3 bays-with later bay added to east end. Windows have small-paned glazing, some with horizontally sliding sashes. One stack to rear of ridge, one to original eastern gable end. Porch with hipped thatched roof. Interior has central full-height room with exposed cruck truss and through parlins. Large fireplace of stone, a C20 feature. House now faces Park Avenue.

Listing NGR: SD2942906534 (5)

CRUCK HOUSE (POST MEDIEVAL to 21ST CENTURY - 1540 AD? to 2050 AD)

- (1) Archive: Ordnance Survey. 1933-1979?. Ordnance Survey Record Card. SD 20 NE 10
 - (2) Archive: Merseyside Sites and Monuments Record. 1977-2011. SMR P sheet. 2906-025
 - (3) Archive: Sibley. Formby Society slides and notes. Slides 366-7 Drawings 242-4
 - (4) Archive: Merseyside Sites and Monuments Record. 1977-2011. SMR F sheet. 2906-025
- Scheduling record: Historic England. The National Heritage List for England.
<http://list.englishheritage.org.uk/resultsingle.aspx?uid=1075865>

Site Number	51
Site Name	No 68 Raven Meols Lane, Formby
Type of Site	House
NHLE List Entry Number	
HER Number	MME11764
Status	Non Designated
Easting	329618
Northing	406574
Parish	Formby
Council	Sefton
Description	No. 68 Raven Meols Lane, Formby. It is unclear if any buildings are shown in the area on Yates' map of 1786. (1) Greenwood's map of 1818 appears to show no building on the site. (2) Hennem's map of 1829 shows a building on the south side of the lane. (3) The Tithe map of 1845 records it as No. 117, house and garden owned by the Reverend Miles Formby and occupied by Henry Tristram. (4-5) HOUSE (GEORGIAN to 21ST CENTURY - 1829 AD? to 2050 AD)

(1) Map: Yates, W.. 1786. Yates' Map of Lancashire.

(2) Map: Greenwood, C.. 1818. Greenwood's Map of the County Palatine of Lancaster.

- (3) Map: Hennet, G.. 1829. Hennet's Map of the County Palatine of Lancaster.
(4) Map: Gregson, W.. 1845. Formby Tithe Map. 117
(5) Documentary source: 1845. Formby Tithe Apportionment. 117

Site Number	52
Site Name	Millstone, Formby Library, Duke Street, Formby
Type of Site	Millston
NHLE List Entry Number	
HER Number	MME11767
Status	Non Designated
Easting	329392
Northing	406886
Parish	Formby
Council	Sefton
Description	<p>A worn millstone was found to the rear of No. 85 Raven Meols Lane, Formby in 1978. It was taken to Formby Library and displayed there sometime after 1979. (1) MILLSTONE (LATE 20TH CENTURY to 21ST CENTURY - 1979 AD? to 2050 AD)</p> <p>Merseyside SMR File Reference - 2906-024 Active (1) Archive: Merseyside Sites and Monuments Record. 1977-2011. SMR F sheet. 2906-024</p>

Site Number	53
Site Name	Possible site of a post medieval windmill, north of Duke Street, Formby
Type of Site	Windmill
NHLE List Entry Number	
HER Number	MME11768
Status	Non Designated
Easting	329500
Northing	406900
Parish	Formby
Council	Sefton
Description	<p>A windmill is shown on Yates' map of 1786, west of the centre of Formby. A road is shown to the southeast and two buildings are shown to the southwest. There is also an arc of buildings to the northwest of the mill, probably intended to represent buildings along what is now Rosemary Lane. This depiction places it somewhere in the vicinity of Dukes Way. (1) The mill is not shown on Greenwood's map of 1818. (2) A millstone was found north of Raven Meols Lane, c.400m to the southeast in 1978 (now on display outside Formby Library). (3) This could indicate the area in which the mill was located, assuming Yates' plotting was inaccurate and that the stone had not been moved far from its place of use. The Tithe map records no fields or lanes with any associated with mills in this area or that around where the millstone was found. (3-4)</p> <p>WINDMILL? (GEORGIAN - 1786 AD? to 1818 AD?)</p> <p>(1) Map: Yates, W.. 1786. Yates' Map of Lancashire. (2) Map: Greenwood, C.. 1818. Greenwood's Map of the County Palatine of Lancaster.</p>

- (3) Archive: Merseyside Sites and Monuments Record. 1977-2011. SMR P sheet. 2906-024
(4) Map: Gregson, W.. 1845. Formby Tithe Map.
(5) Documentary source: 1845. Formby Tithe Apportionment.
-

Site Number	54
Site Name	Site of a House, Church Road, Formby
Type of Site	House
NHLE List Entry Number	
HER Number	MME1394
Status	Non Designated
Easting	330189
Northing	407087
Parish	Formby
Council	Sefton
Description	<p>Former site of a house, Church Road, Formby. (1) No building is shown in the area on Yates' map of 1786. (2) Greenwood's map of 1818 appears to show the building. (3) The Tithe map of 1845 records it as No. 356, a cottage and garden owned by Thomas Weld Blundell and occupied by Joseph Formby. (4-5) The building is last recorded on the 1st edition 6" OS map of 1848; it does not appear on the 1st edition 25" OS map of 1893.</p> <p>HOUSE (GEORGIAN to VICTORIAN - 1818 AD? to 1893 AD?)</p> <p>(1) Archive: Merseyside Sites and Monuments Record. 1977-2011. SMR P sheet. 3007-013 (2) Map: Yates, W.. 1786. Yates' Map of Lancashire. (3) Map: Greenwood, C.. 1818. Greenwood's Map of the County Palatine of Lancaster.</p>

Site Number	55
Site Name	Sewage Works
Type of Site	Works
NHLE List Entry Number	
HER Number	
Status	Non Designated
Easting	329671
Northing	406116
Parish	Formby
Council	Sefton
Description	<p>The Sewage Works first appear on the 1906 Ordnance Survey along Altacr Lane. By the Survey in 1938 the works have expanded to the east and this expansion continues into another eastern field in 1955. The Ordnance Survey map of 1974 shows the expansion of the works south and the erection of large standing towers. The entire complex is large in scale and well illustrated in the map of 1985. The works are currently being upgraded as of 2012.</p>

Site Number	56
Site Name	Embankment
Type of Site	Embankment
NHLE List Entry Number	
HER Number	
Status	Non Designated
Easting	330059
Northing	406115
Parish	Formby
Council	Sefton
Description	An embankment along the field line

Site Number	57
Site Name	Water course
Type of Site	River
NHLE List Entry Number	
HER Number	
Status	Non Designated
Easting	330492
Northing	405851
Parish	Formby
Council	Sefton
Description	The old line of the River Alt, labelled the "Union Body" in the 1892 2nd Edition Ordnance Survey. The River was redirected in the late 1970's or early 1980's

Site Number	58
Site Name	Hoggshill Farmhouse
Type of Site	Listed Building
NHLE List Entry Number	1075885
HER Number	
Status	Listed Building (II)
Easting	329712
Northing	406210
Parish	Formby
Council	Sefton
Description	ALTCAR HOGGSHILL LANE SD 20 NE (south side) 2/7 No. 11 (Hoggshill 19.7.74 Farmhouse) G.V. II Houses. Possibly c.1600 with much later alteration. Cement-rendered brick with C20 pantile roof. One storey with attic. South facade to former farm yard of 3 bays, small-paned casement and 2 horizontally sliding sashes. Central stack to ridge and gable-end stack. Central gabled porch with elliptical-headed entrance. North facade to street has segmental-headed small-

paned casements and raking dormers. Interior has original close-set ceiling beams to ground floor.

Site Number	59
Site Name	Barn to East of Grange Farm
Type of Site	Listed Building
NHLE List Entry Number	1075866
HER Number	
Status	Listed Building (II)
Easting	329350
Northing	404931
Parish	Ince Blundell
Council	Sefton
Description	<p>INCE BLUNDELL GRANGE ROAD SD 20 SE (west side) 5/59 Barn to east 04.04.77 of Grange Farm (formerly listed II under Hightown) Barn. c.1550. Brick on stone base, stone slate roof. 6 bays, eastern end bay separated by cross wall. On south side, to right of 3rd bay entrance, a 4-bay projecting cow house under cat slide roof. Roof has collar and strut trusses, the southern ends resting on triangular buttresses, and through purlins with some wind braces. Eastern end has entrance between battered buttresses with pitching hole, some ventilation slits. To north, an entrance with cheeks and 2 large battered buttresses; end outshut. Interior has niches for holy water stoups in buttresses flanking south entrance and 2 battered buttresses to south wall. Used as Catholic chapel in late C17, q.v. Cross Barn, Cross Barn Lane.</p> <p>Listing NGR: SD2935004931</p>

Site Number	60
Site Name	Moss Farmhouse
Type of Site	Listed Building
NHLE List Entry Number	1075868
HER Number	
Status	Listed Building (II)
Easting	330241
Northing	404853
Parish	Ince Blundell
Council	Sefton
Description	<p>INCE BLUNDELL NORTH END LANE SD 30 SW (north side) 6/66 Moss Farmhouse II Farmhouse. Late C17 with later additions. Cruck frame; lime washed brick with corrugated iron roof, end 2 bays form lower addition. Windows have C20 casements. Entrance in porch between 1st and 2nd bays, end glazed entrance doors. Gable-end stacks and one cross-axial stack. Interior has one complete cruck truss and 2 trusses with only one remaining timber.</p> <p>Listing NGR: SD3024104853</p>

Appendix 9.2: AS 28 Figures

Figure AS 28- 1

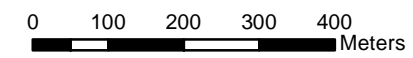
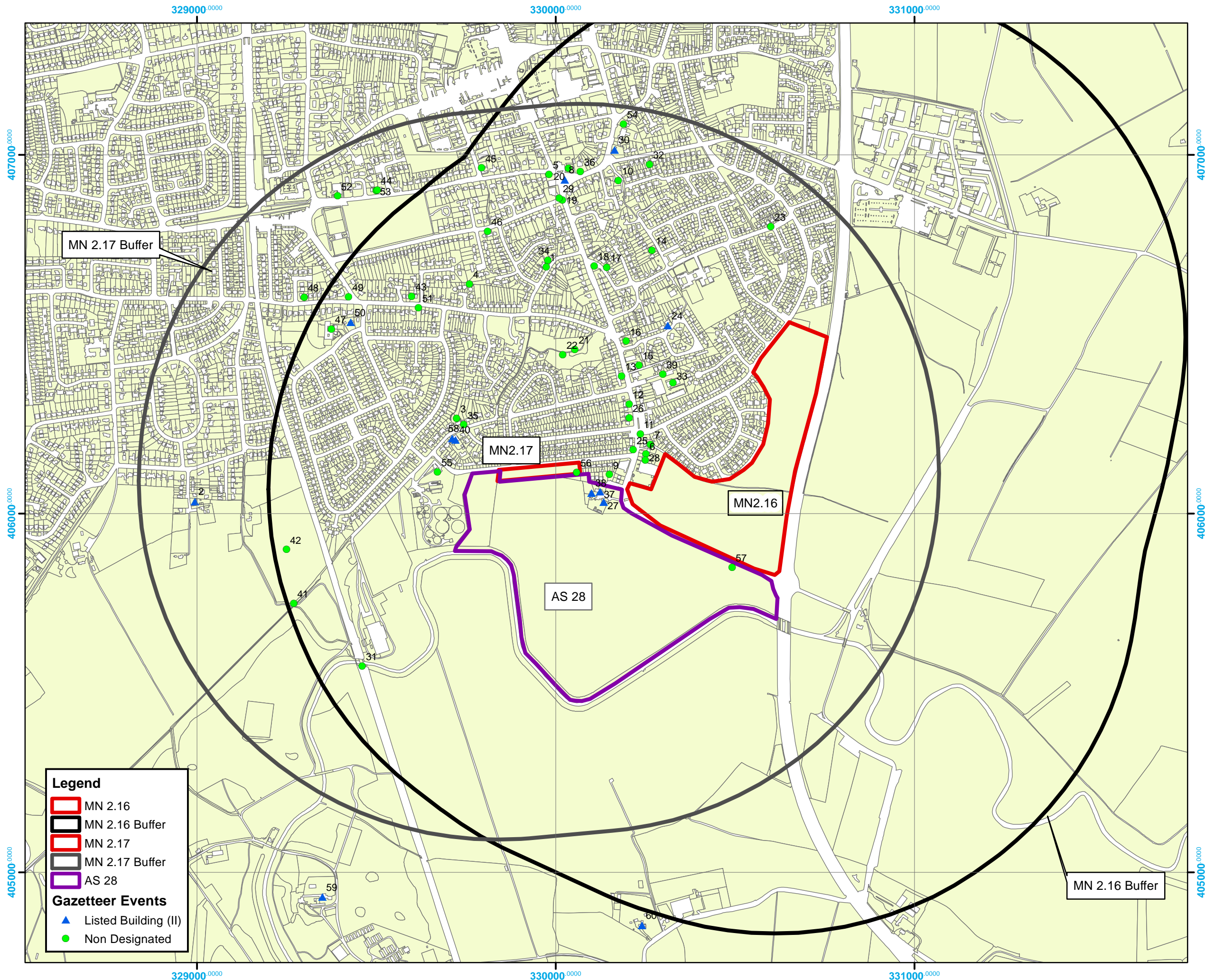

Mapping supplied by Sefton Metropolitan Borough Council

Project No.:	23211
Date:	29.10.2015
Scale at A3:	1:10,000



(c) AOC Archaeology 2015



Figure AS 28- 2

1769
Altcar Estate Map

Approximate proposed
site allocation location

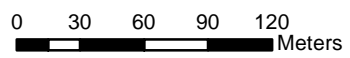

Reproduced from Lancaster Record Office DDM/14/20

Project No.:	23211
Date:	29.10.2015
Scale at A3:	1:3,550



(c) AOC Archaeology 2015



Figure AS 28- 3

1778
Plan of Damaged
Land Adjoining
the River Alt

Approximate proposed
site allocation location

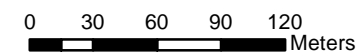

Reproduced with the permission of
the Lancashire Records Office CSA/44

Project No.:	23211
Date:	29.10.2015
Scale at A3:	1:3,550

Legend
AS 28



(c) AOC Archaeology 2015

330000.0000

406000.0000

406000.0000



Legend
 AS 28

330000.0000

Figure AS 28- 4

1780
Altcar Estate Map

Approximate proposed
site allocation location

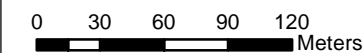

Reproduced with the permission of
the Lancashire Records Office DDM/14/21a

Project No.:	23211
Date:	29.10.2015
Scale at A3:	1:3,550



(c) AOC Archaeology 2015

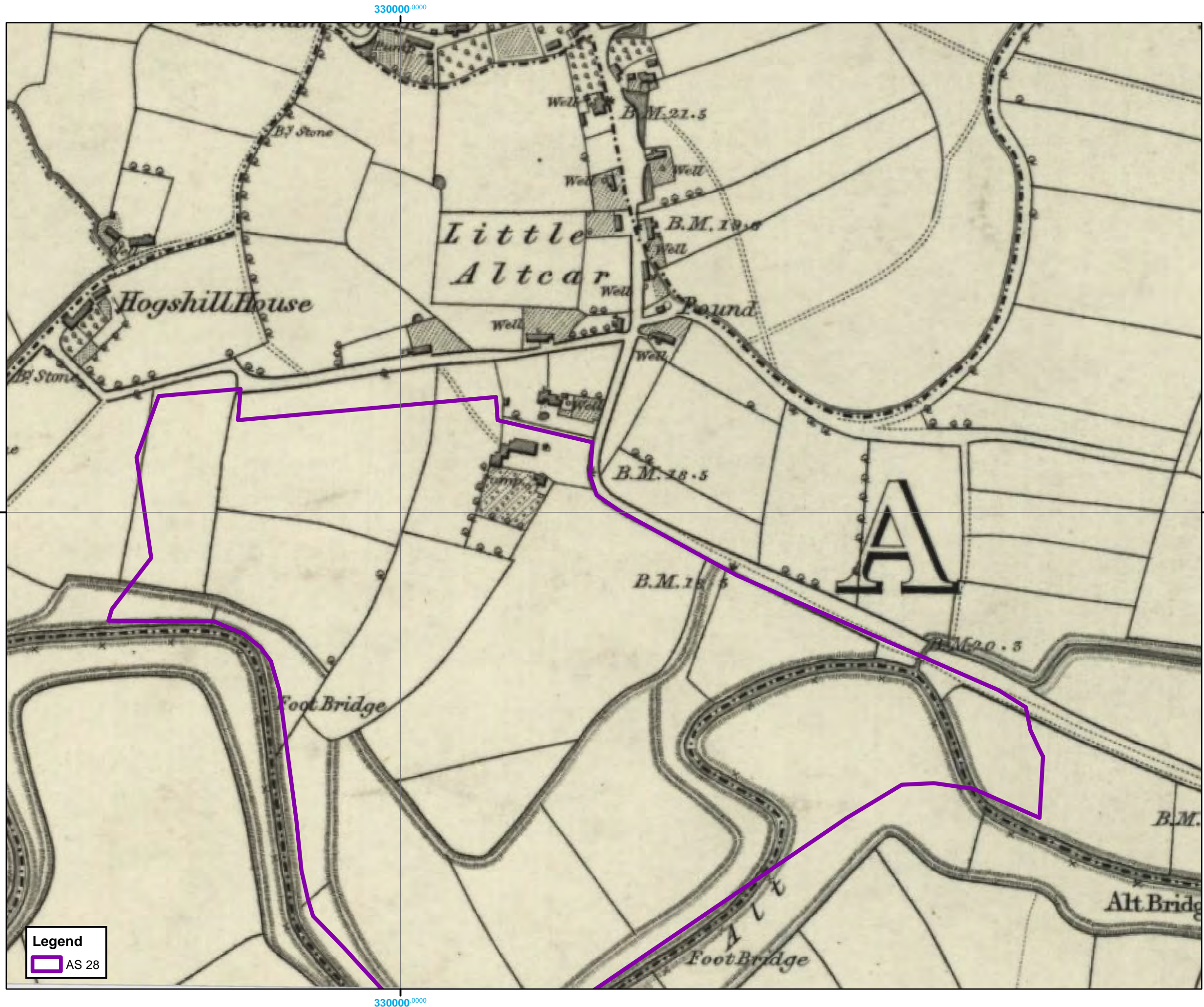

406000.0000

330000.0000

406000.0000

330000.0000

Legend
 AS 28

Figure AS 28- 5
 1845-6 1st Edition
 Ordnance Survey



Reproduced with the kind permission of
 the Trustees of the National Library of Scotland

Project No.:	23211
Date:	29.10.2015
Scale at A3:	1:3,550

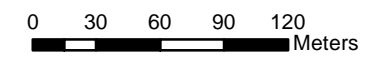

(c) AOC Archaeology 2015

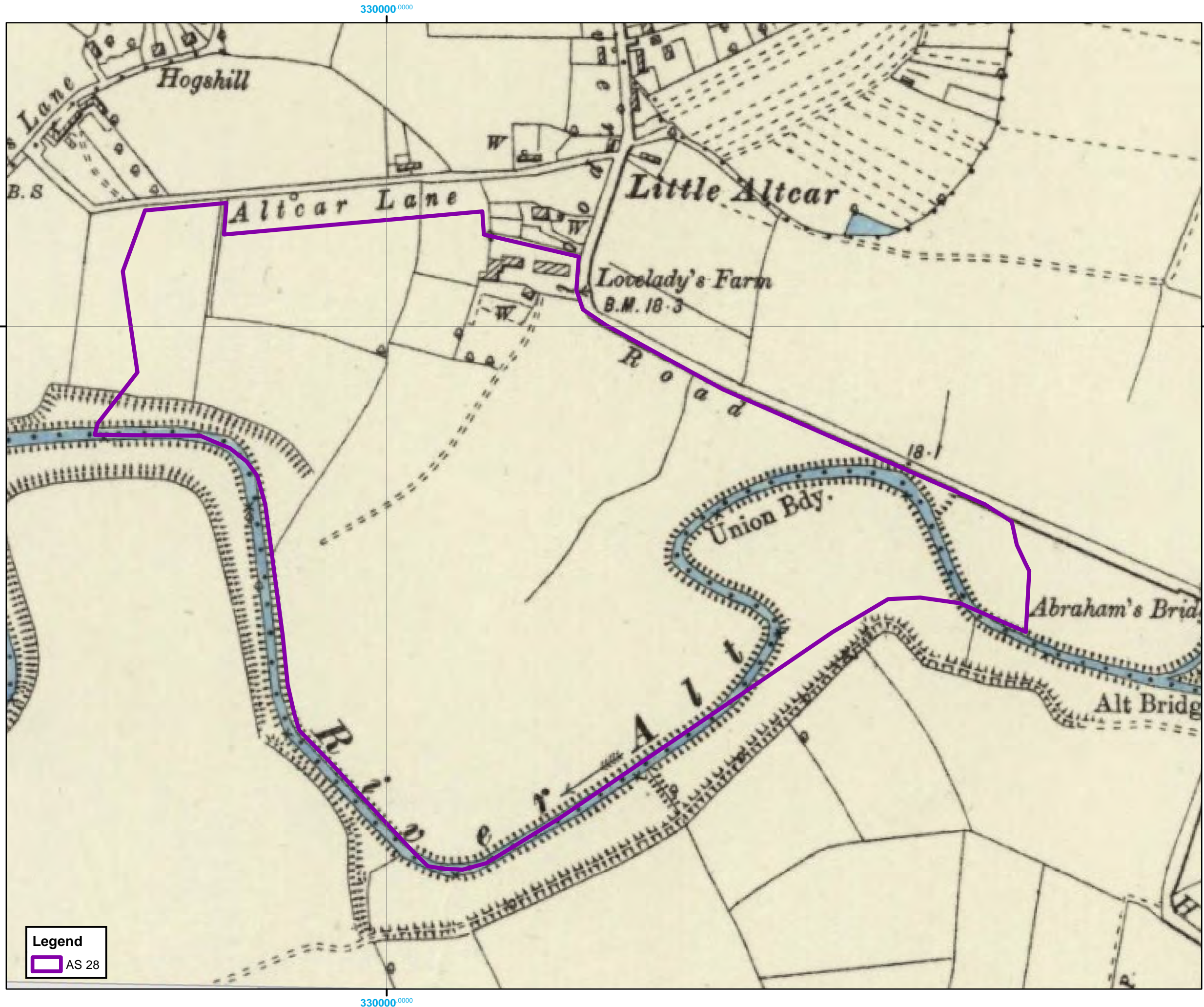
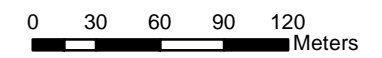

Figure AS 28- 6
 1892 2nd Edition
 Ordnance Survey



Reproduced with the kind permission of
 the Trustees of the National Library of Scotland

Project No.:	23211
Date:	29.10.2015
Scale at A3:	1:3,550



(c) AOC Archaeology 2015

330000.0000

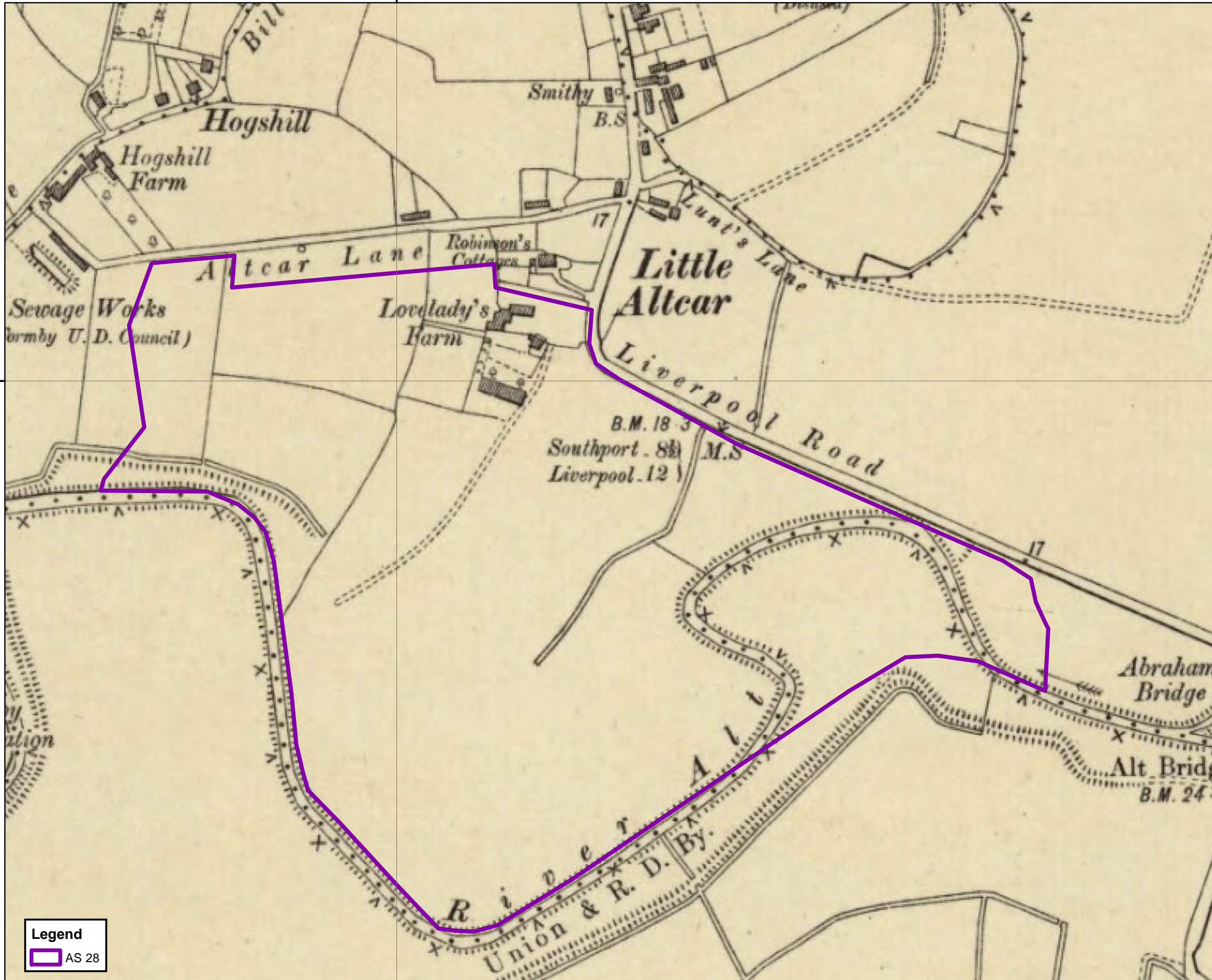

Legend

AS 28

330000.0000

Figure AS 28- 7

1906
Ordnance Survey

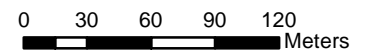

Reproduced with the kind permission of
the Trustees of the National Library of Scotland

Project No.:	23211
Date:	29.10.2015
Scale at A3:	1:3,550



(c) AOC Archaeology 2015

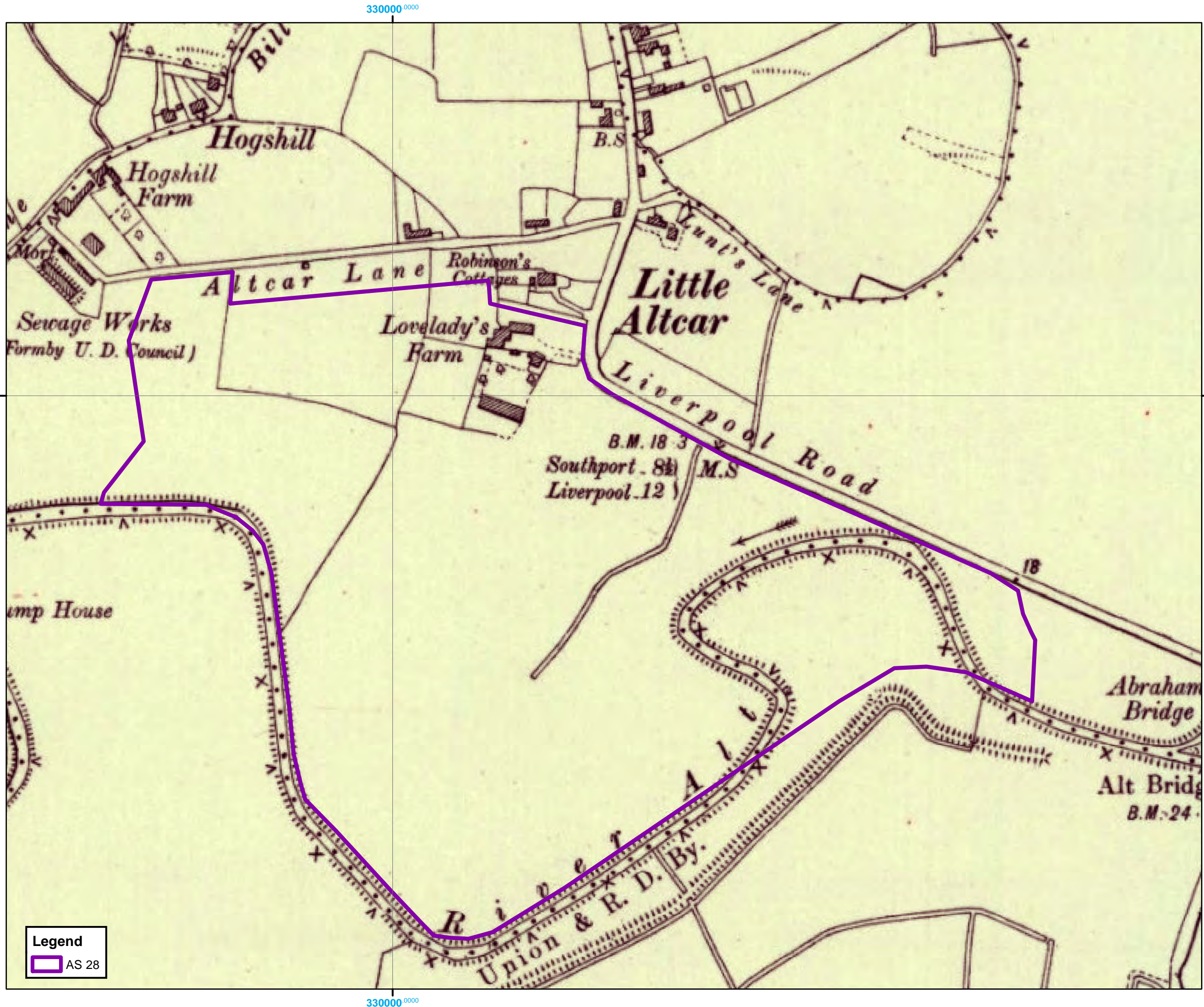
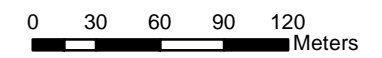



Figure AS 28- 8
 1925-6
 (published c. 1934)
 Ordnance Survey



Reproduced with the kind permission of the Trustees of the National Library of Scotland

Project No.:	23211
Date:	29.10.2015
Scale at A3:	1:3,550

Legend
 AS 28



(c) AOC Archaeology 2015

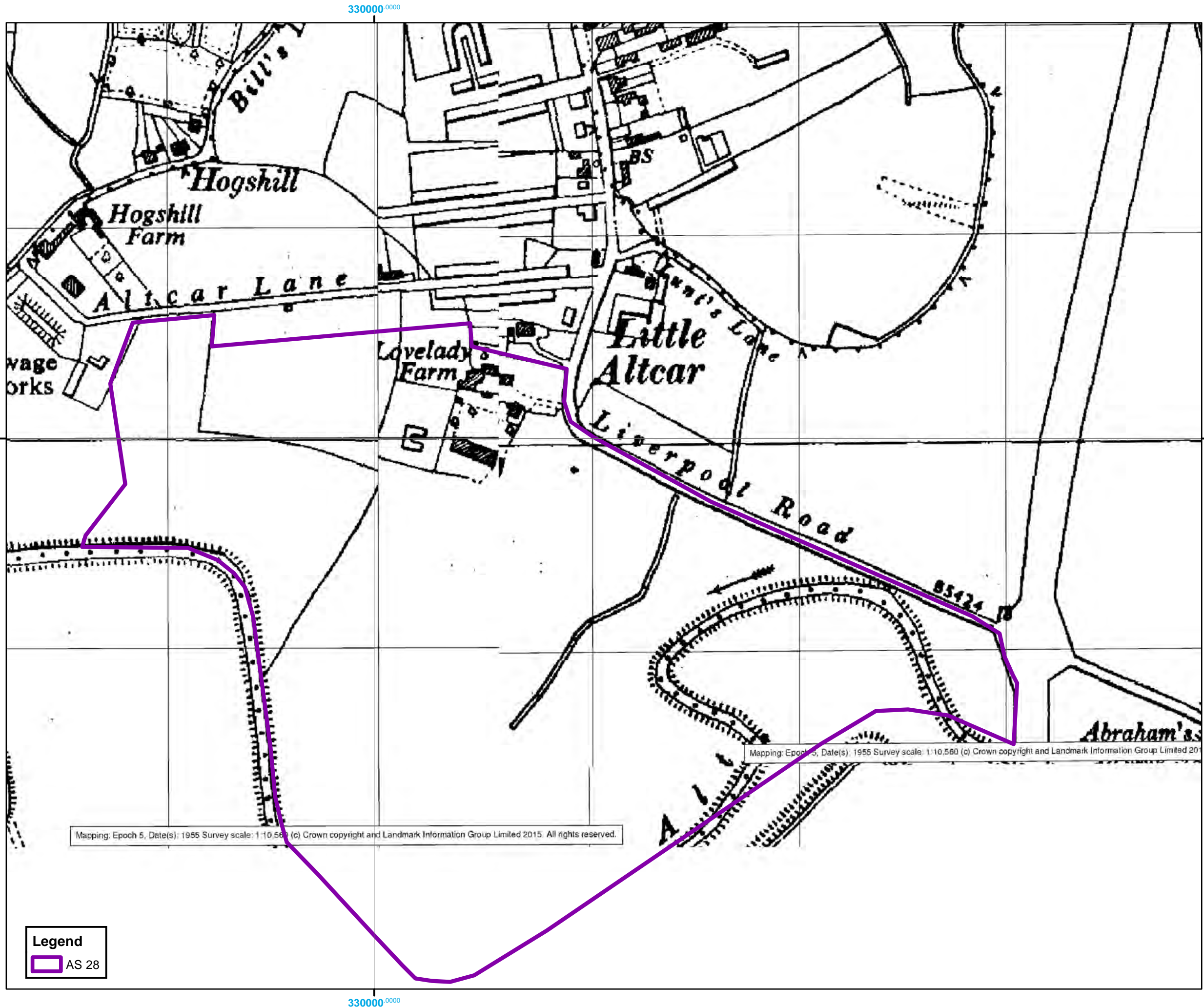
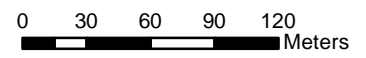

Figure AS 28- 9
1955
Ordnance Survey



Contains Ordnance Survey data
© Crown Copyright and database right [2015]
North
© Historic England [2015].
© Crown Copyright and database right [2015].
All rights reserved.
Ordnance Survey Licence number 100024900

Project No.:	23211
Date:	29.10.2015
Scale at A3:	1:3,550



(c) AOC Archaeology 2015

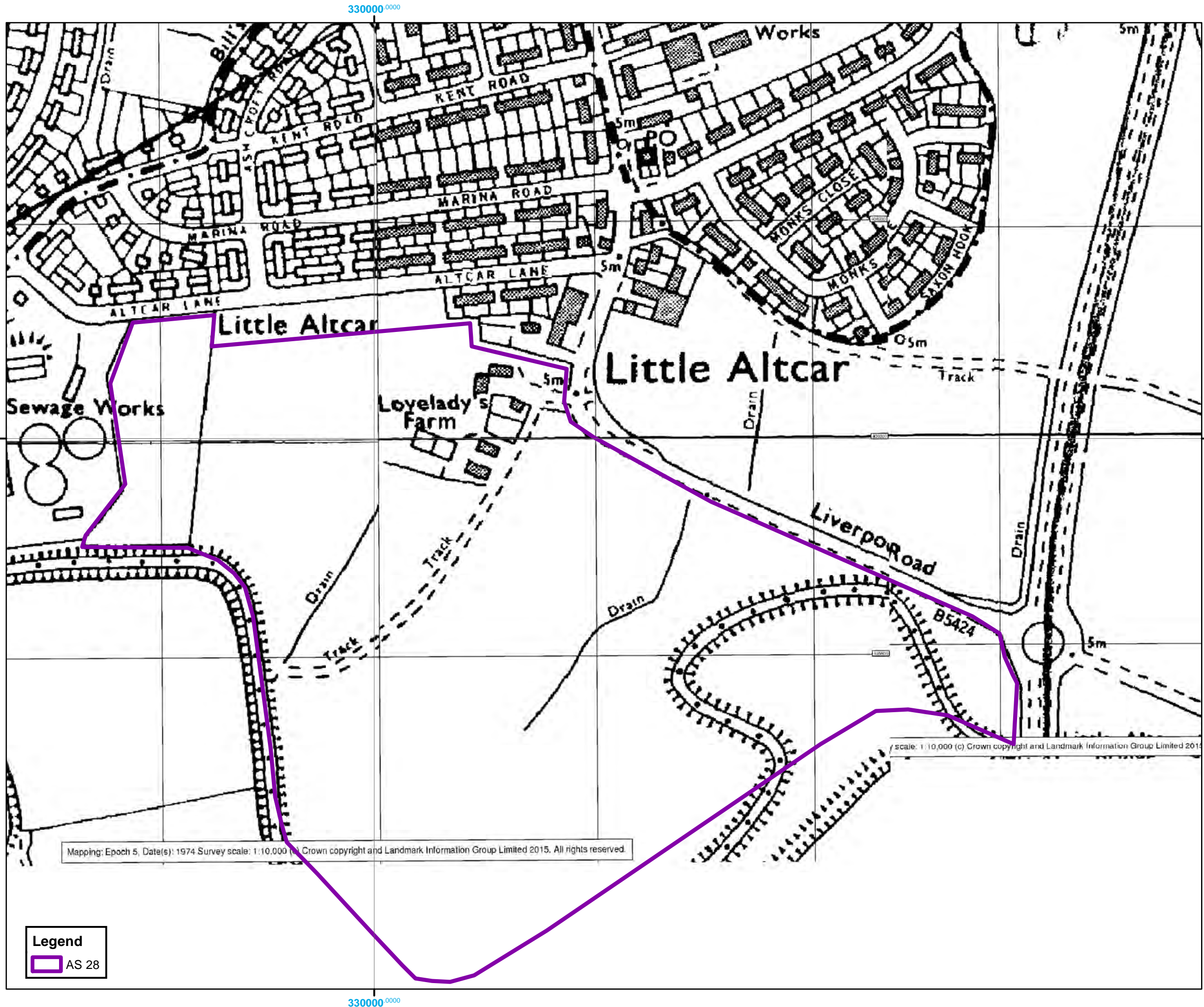
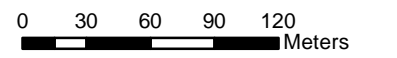

Figure AS 28- 10
1974
Ordnance Survey



Contains Ordnance Survey data
© Crown Copyright and database right (2015)
North
© Historic England (2015).
© Crown Copyright and database right (2015).
All rights reserved.
Ordnance Survey Licence number 100024900

Project No.:	23211
Date:	29.10.2015
Scale at A3:	1:3,550



(c) AOC Archaeology 2015

Mapping: Epoch 5, Date(s): 1974 Survey scale: 1:10,000 (c) Crown copyright and Landmark Information Group Limited 2015. All rights reserved.

Legend
AS 28

Appendix 9.3: AS 28 Plates



Plate AS 28-1 - Panorama from Liverpool Road looking South over the Proposed Allocation Site AS 28



Plate AS 28-2- Panorama from MN 2.17 looking South East over the Proposed Allocation Site AS 28



AOC Archaeology Group, Edgefield Industrial Estate, Edgefield Road, Loanhead EH20 9SY
tel: 0131 555 4425 | fax: 0131 555 4426 | e-mail: edinburgh@aocarchaeology.com

www.aocarchaeology.com